

Practice

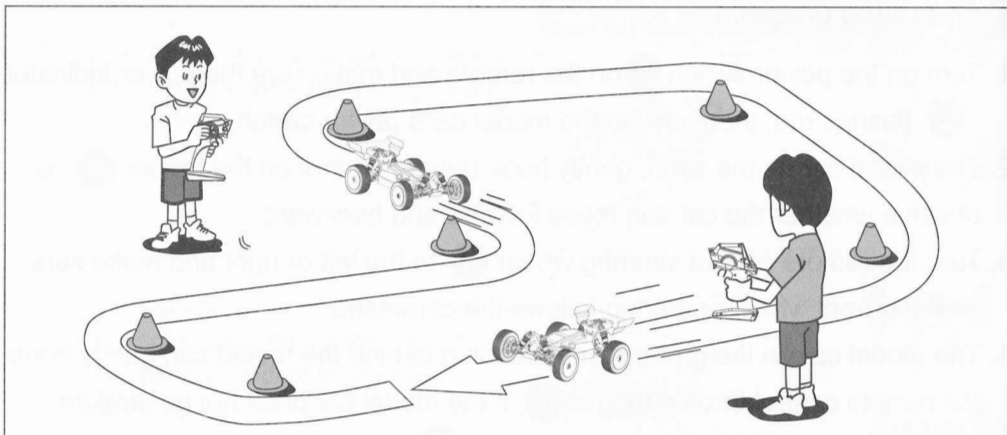

Let's practice! Make R/C car circuit at a wide and safe location using corner pylons (separately available), empty cans or such. Running fast at straight section and slow down at curved section is a basic speed control technique useful when driving R/C car.

Maintain

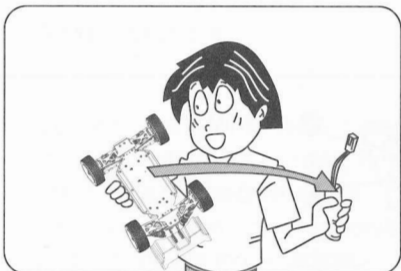

When the car is not in use, you should remove the battery from the car.



Completely remove sand, mud, dirt etc.

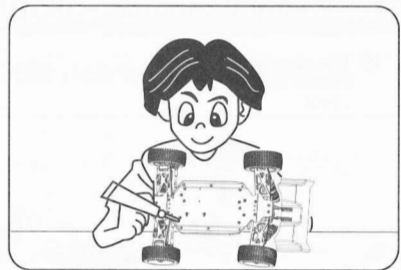

Metal outside should apply the rust prevention oil.

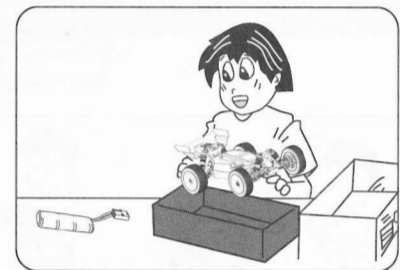

Store the car and batteries separately when not in use.

Assembly Exploded Diagram

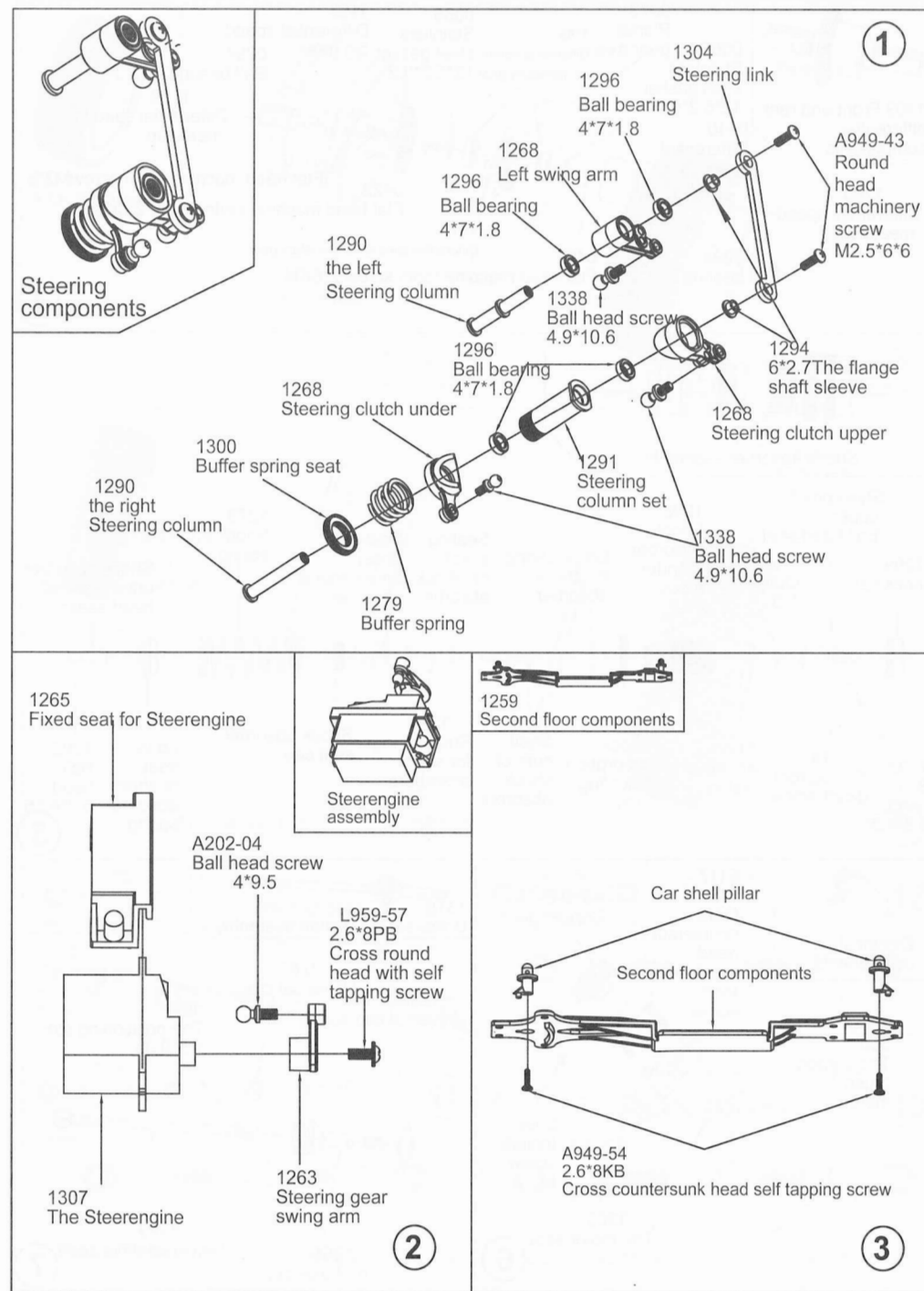

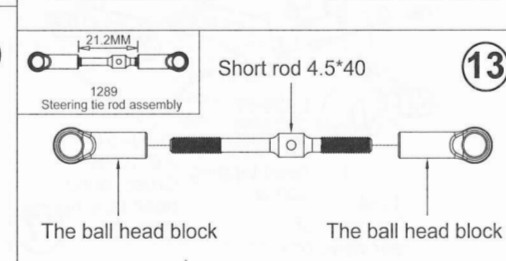
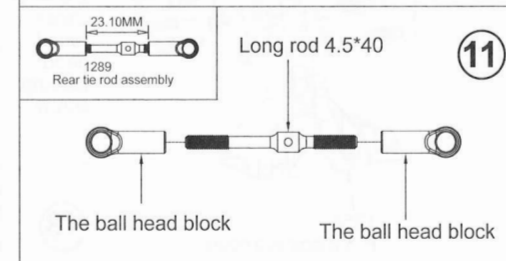
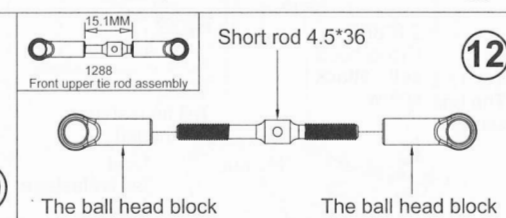
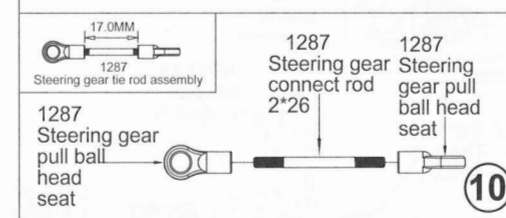
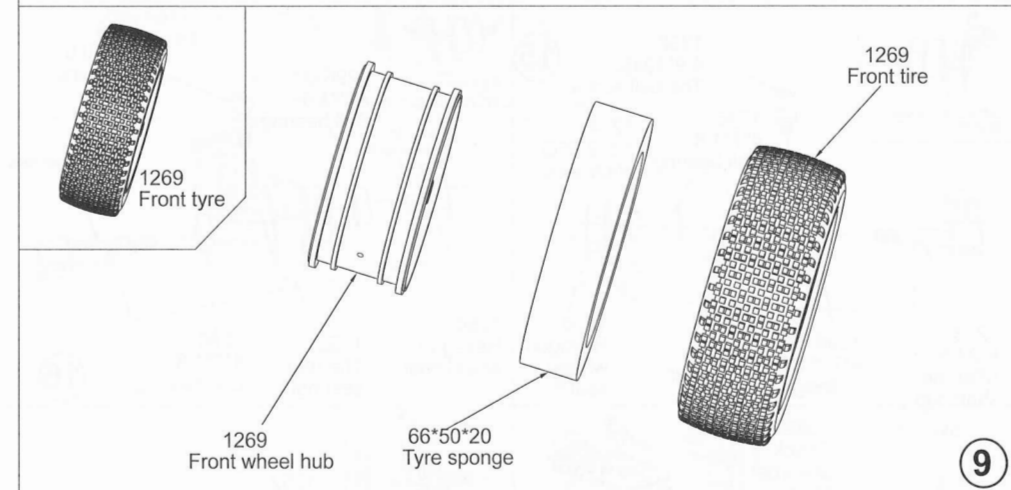
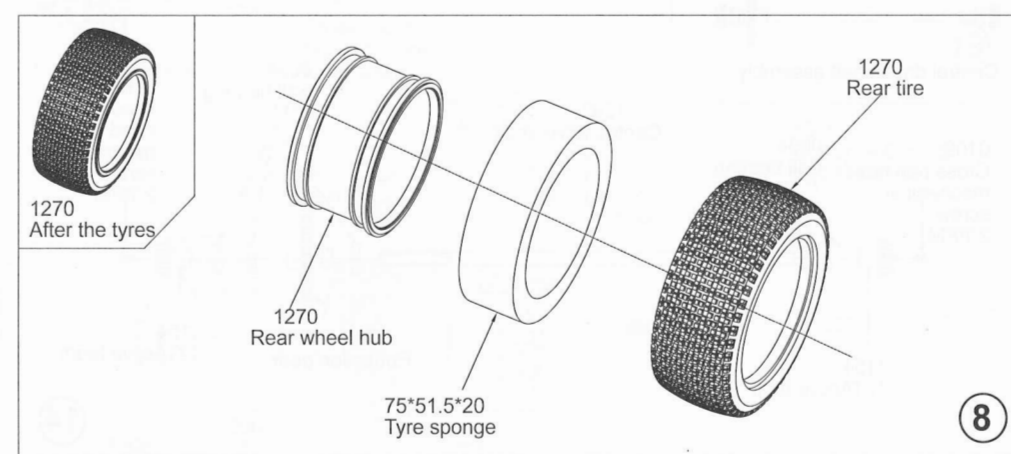
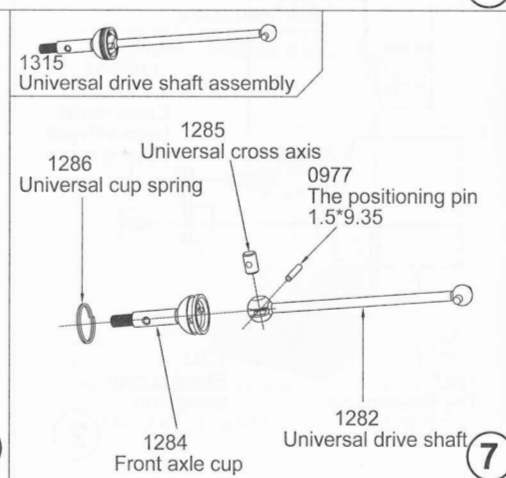
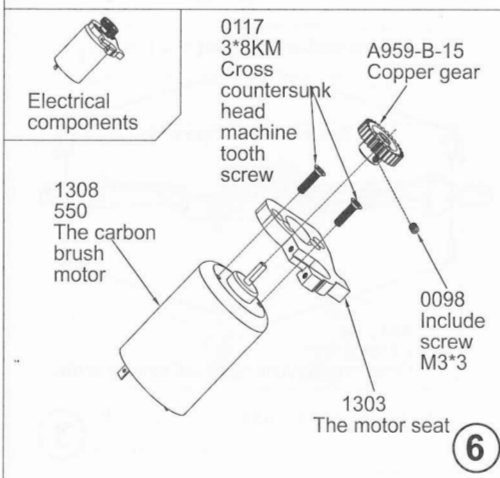
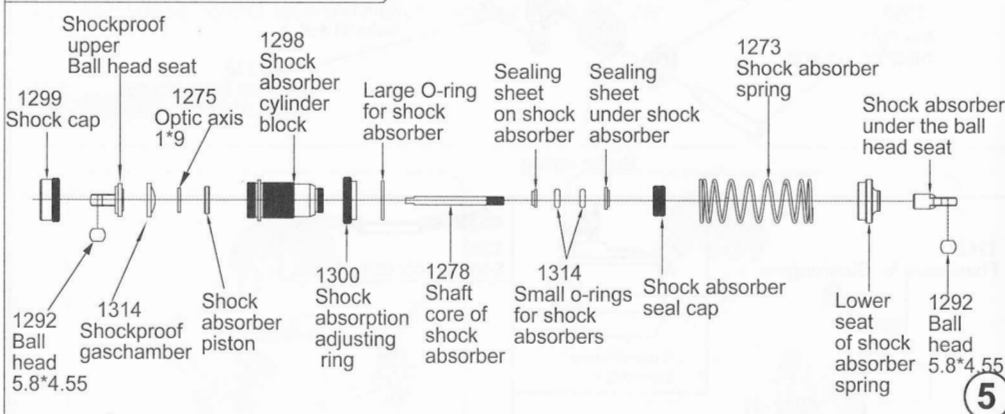
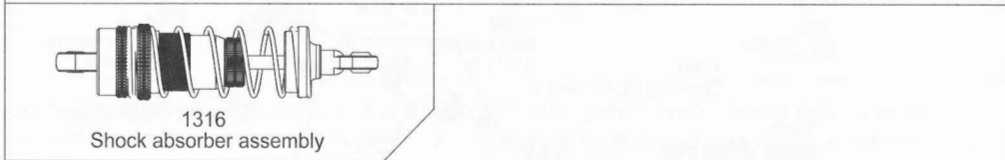
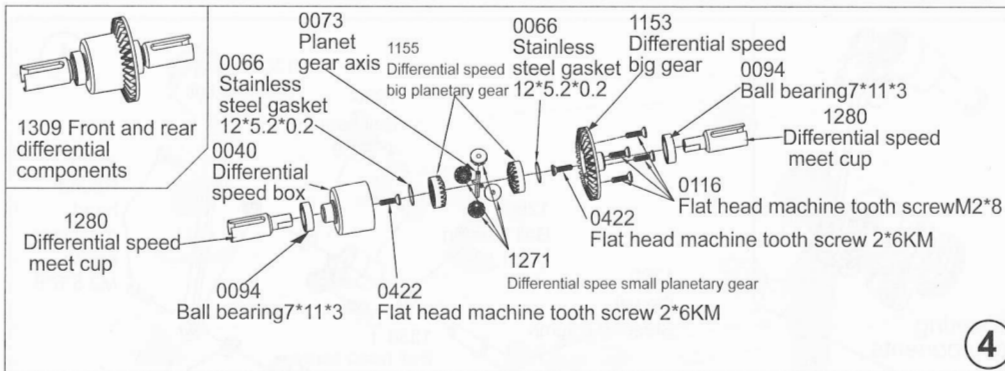

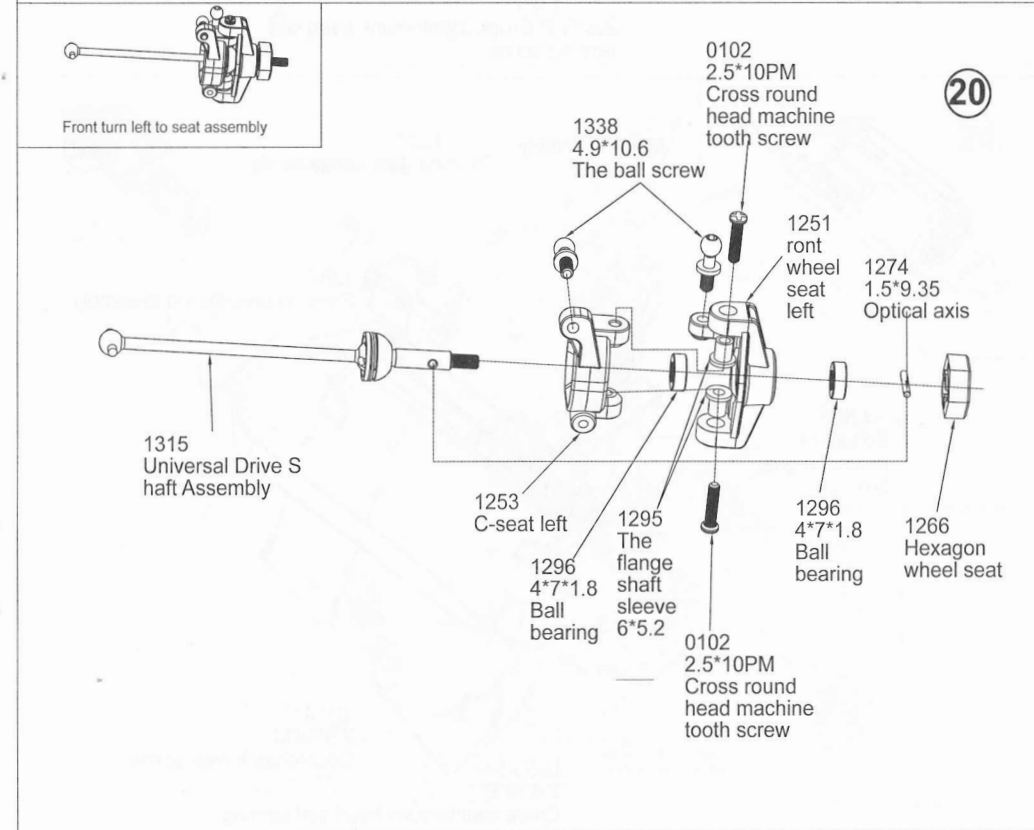
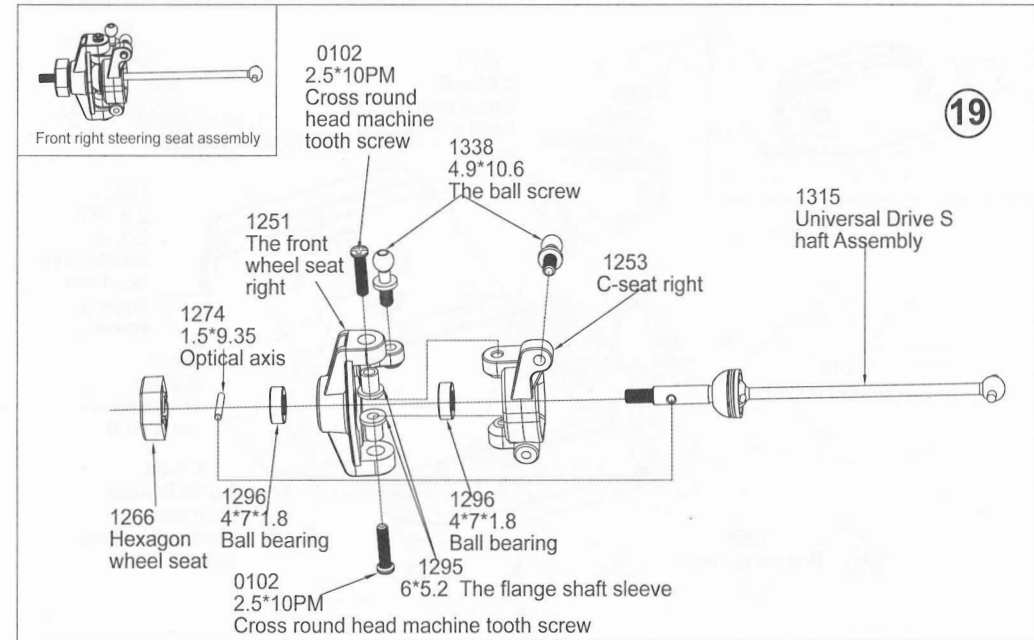
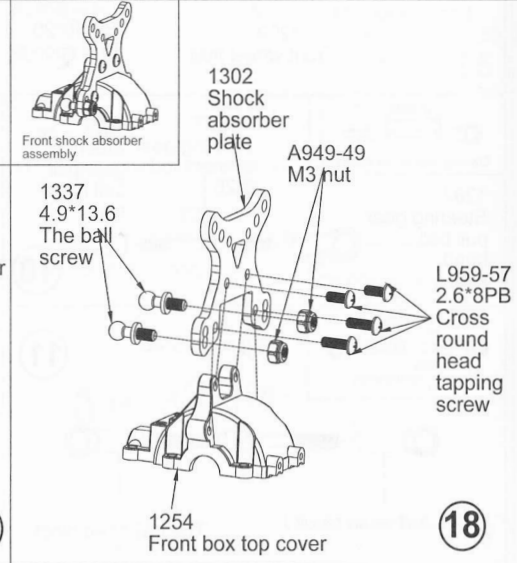
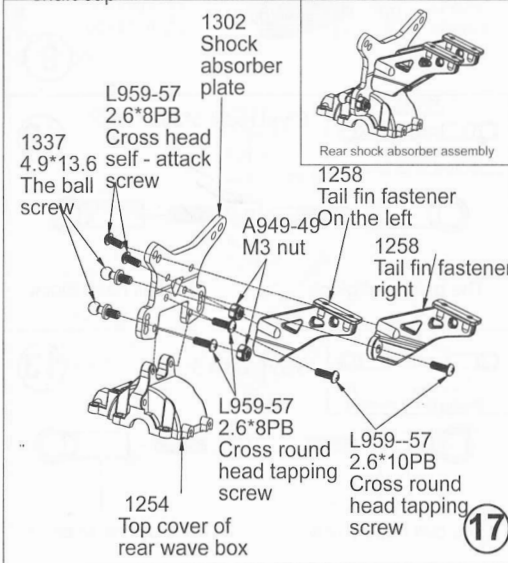
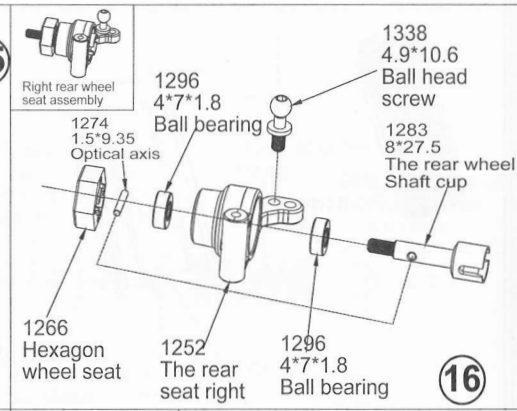
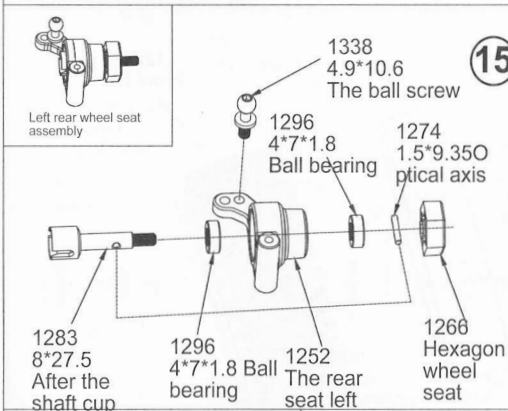
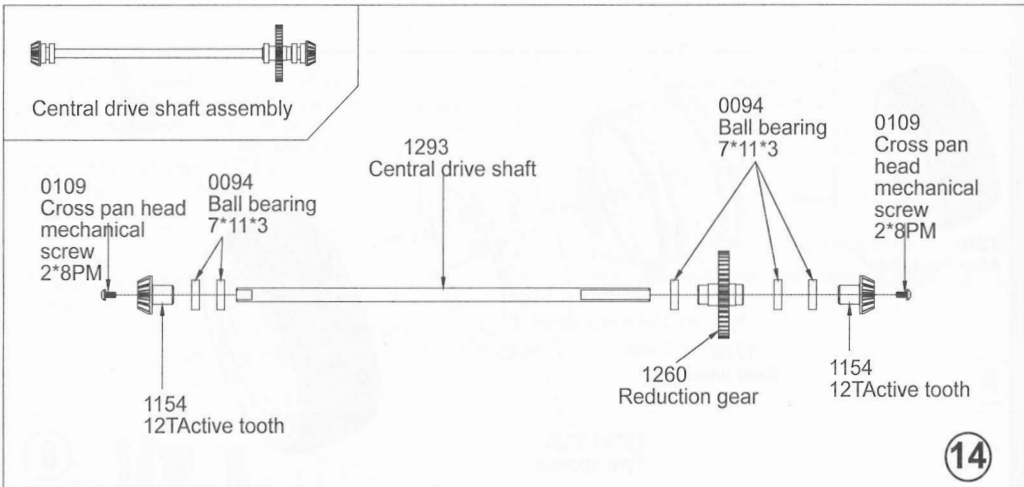

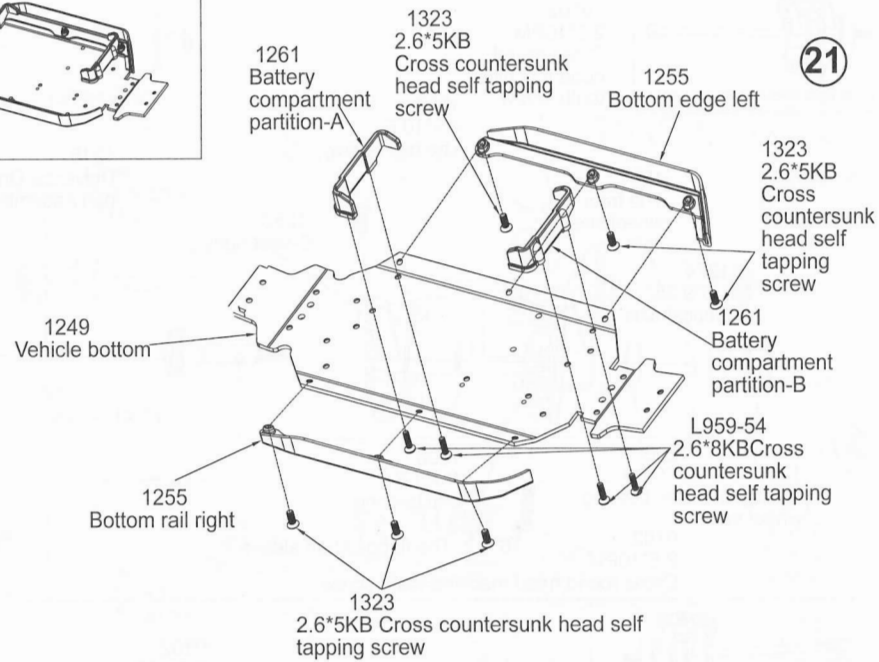
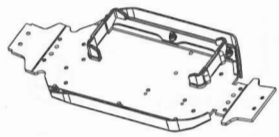

21

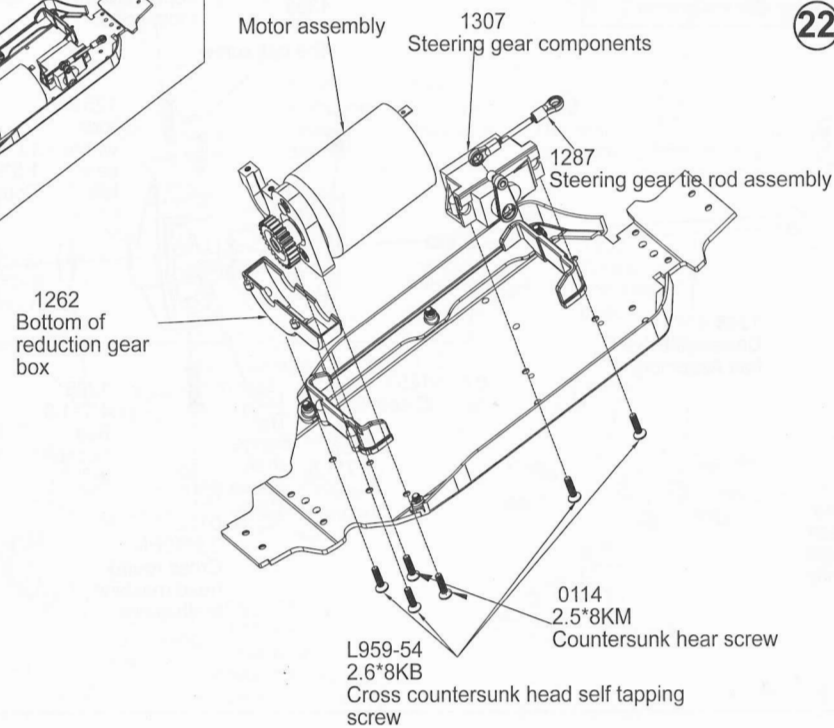
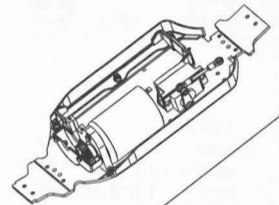

22

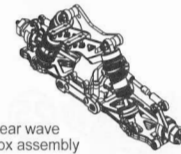

Rear wave box assembly

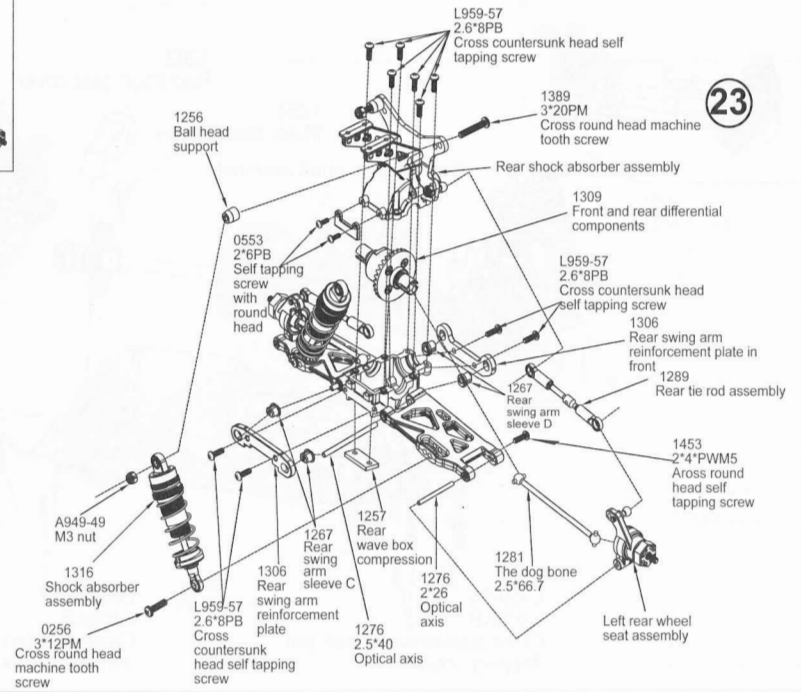

23

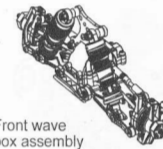

Front wave box assembly

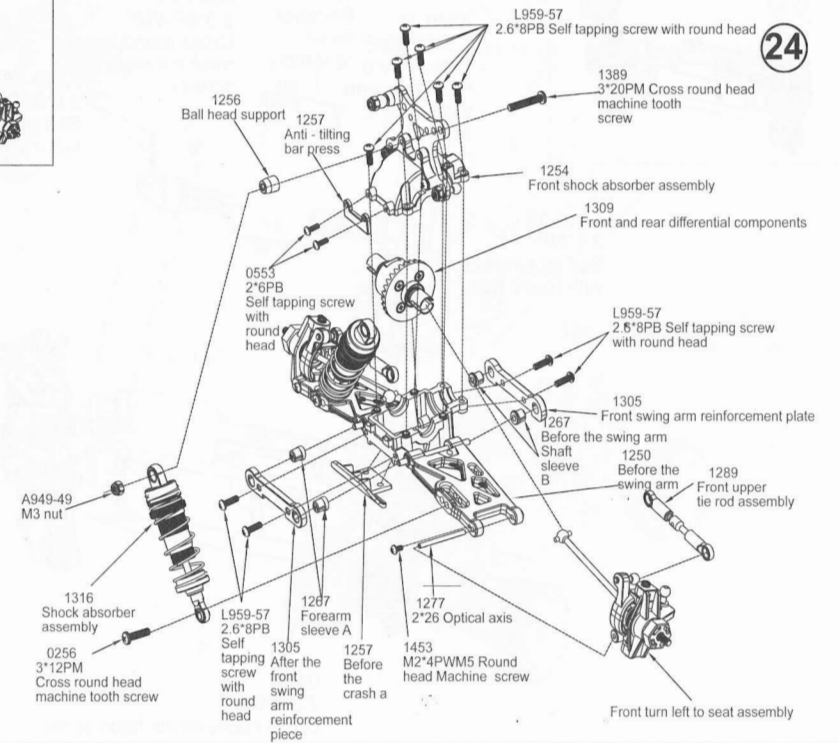

24

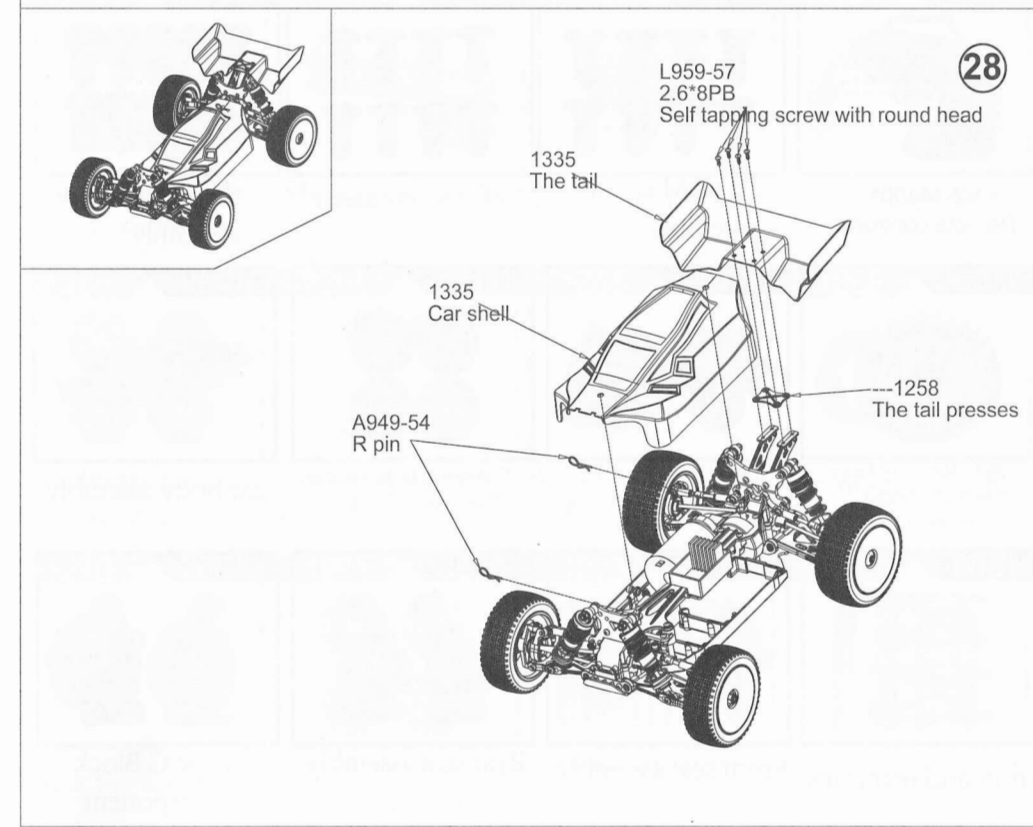
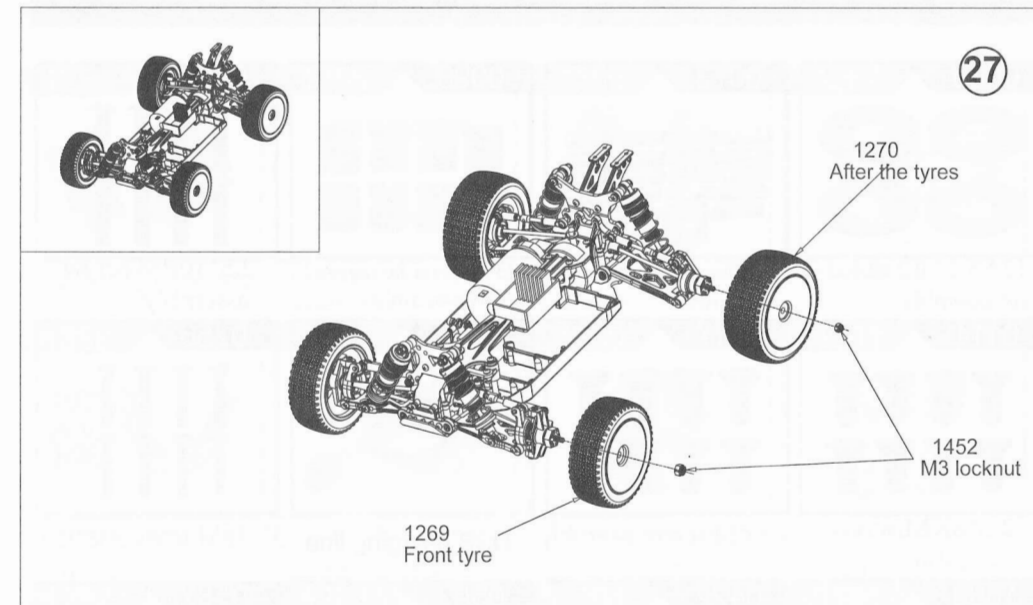
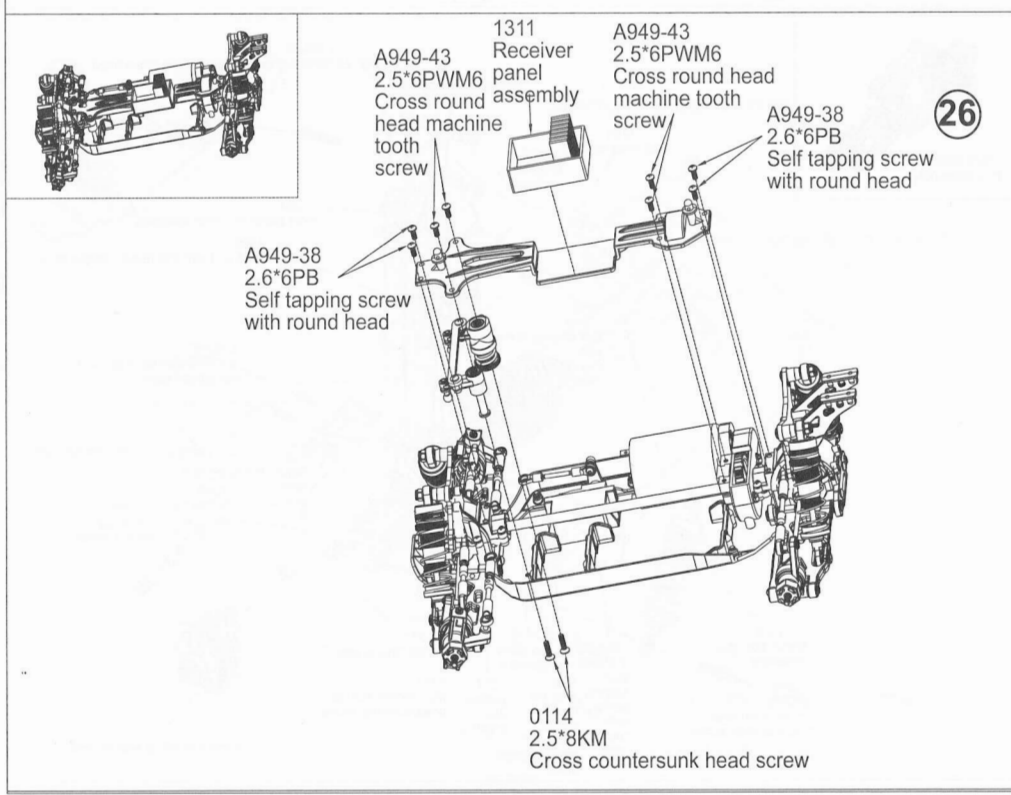
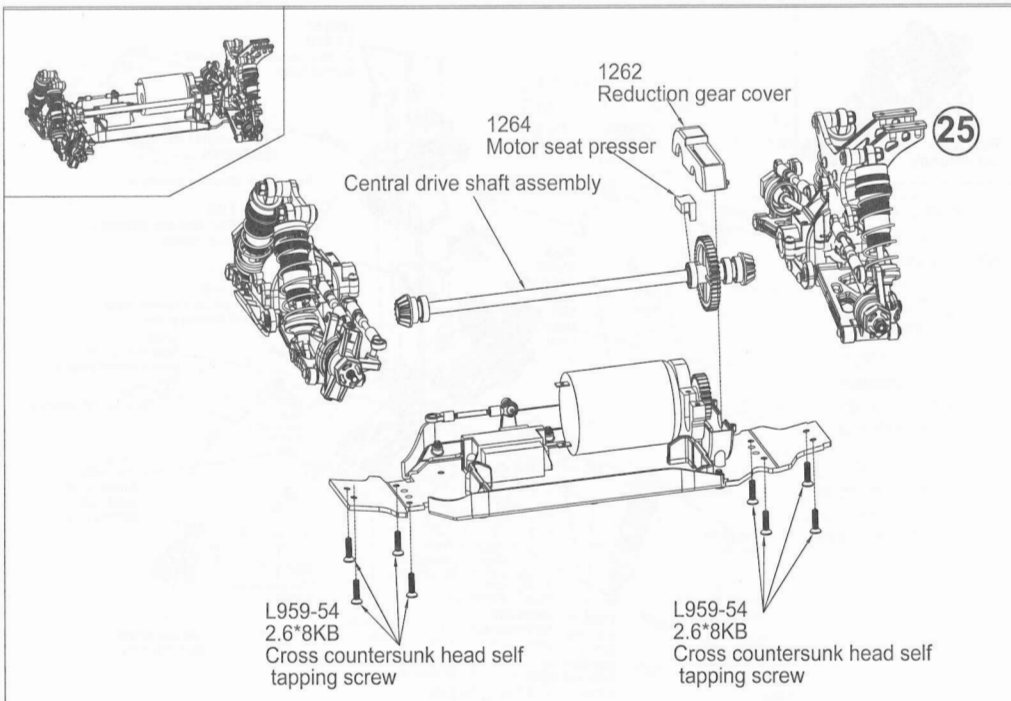

Sale parts view

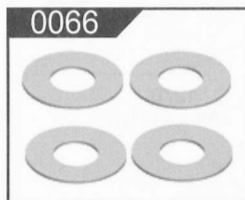

0066

12 * 5.2 * 0.2 gasket set assembly

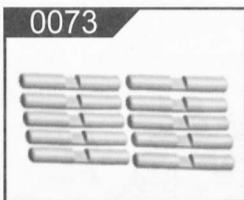

0073

Differential shaft assembly

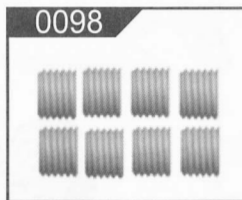

0098

M3*3 Inner hexagonal screw assembly

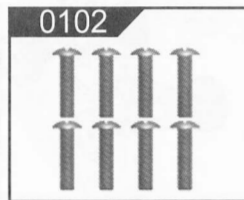

0102

2.5*10PM screw assembly



0114

2.5*8KM screw assembly



0117

3*8KM screw assembly

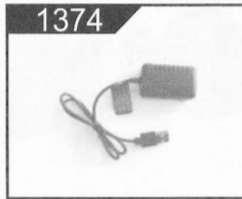

1374

USB charging line

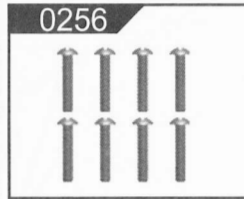

0256

3*12PM screw assembly



1669

V2-144001 Remote controller



0422

2 * 6KM screw assembly



0553

2 * 6PB screw assembly



0582

ST2*7PB screw assembly



1153

30T Differential Large Teeth(Hardware) Component

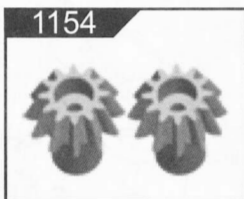

1154

12T Active Teeth(Hardware) Group

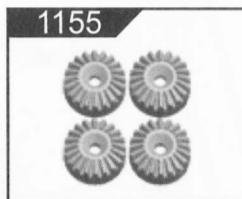

1155

24T Differential Large Planetary Teeth(Hardware) Group

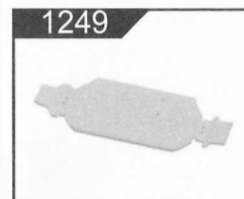

1249

car body assembly

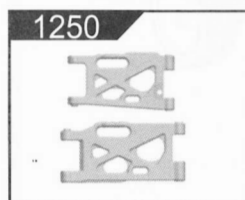

1250

Front and rear arms

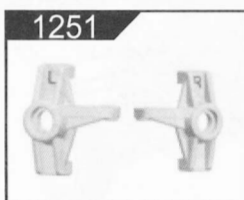

1251

Front seat assembly



1252

Rear seat assembly



1253

Type C Block Component

Sale parts view

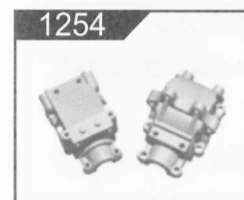

1254

Wave Box Component



1255

Bottom side guard assembly

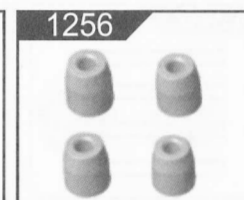

1256

Ball head support assembly

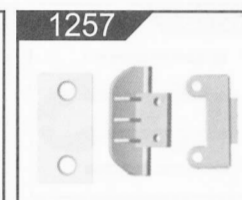

1257

Anti-collision accessories components

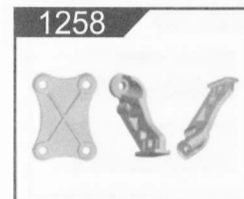

1258

Final-end firmware component



1259

Second floor panel components

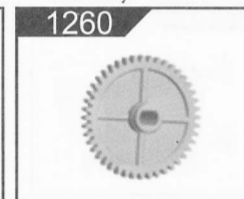

1260

Slow down large tooth assembly

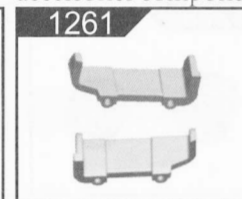

1261

Battery partition assembly



1262

Speed gear upper and lower cover assembly



1263

Tiller arm assembly



1264

Motor seat press component

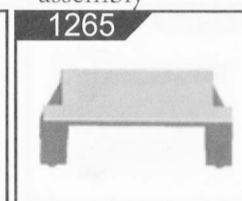

1265

Steering seat press assembly



1266

Hexagonal seat assembly

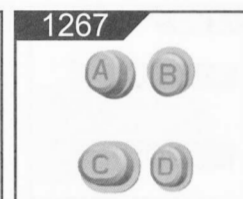

1267

Front and rear arm sleeve



1268

Switch to clutch component

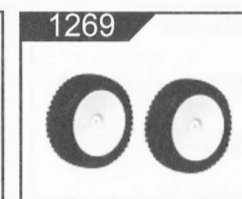

1269

Front tire assembly

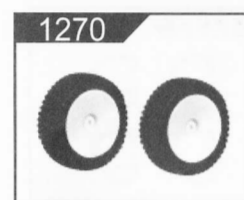

1270

Back tire assembly

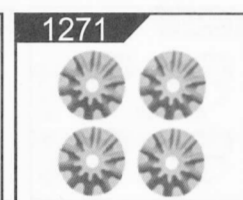

1271

10T Differential Asteroid Teeth(Hardware) Group



1273

Shock absorber spring assembly



1274

1.5*9.35 Optical axis

Sale parts view

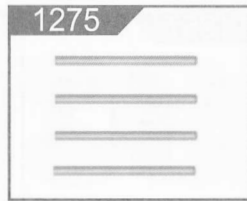

1*9 Optical axis

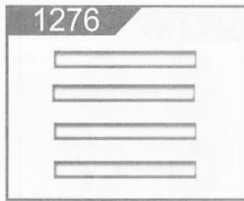

2.5*40 Optical axis

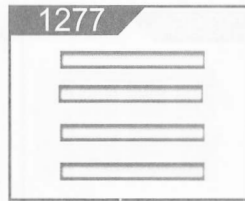

2*26 Optical axis

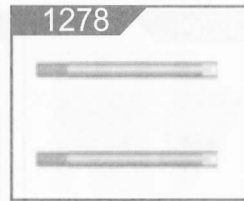

Shock absorber shaft component

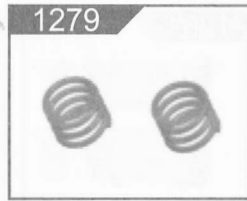

Buffer spring assembly



Dog bone assembly

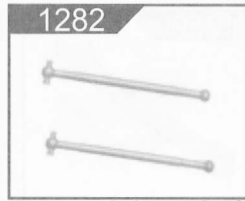

Universal drive shaft assembly

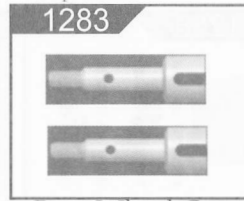

Rear Wheel Cup Component

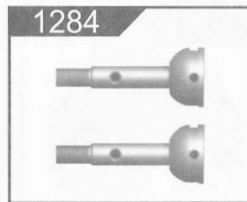

Front Wheel Cup Component

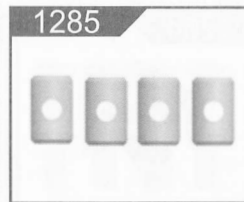

Cross shaft assembly



Universal cup spring assembly



Steering gear lever assembly

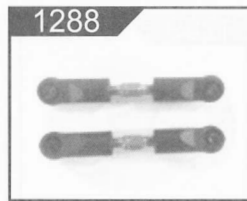

Short pull bar assembly



Long pull bar assembly

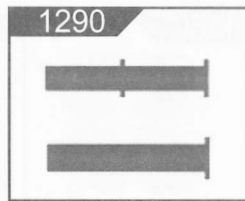

Steering column assembly



Steering column sleeve component

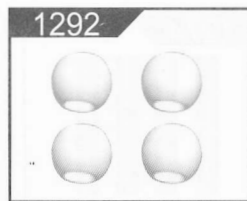

Ball Head Component



Central Transmission Axis Component

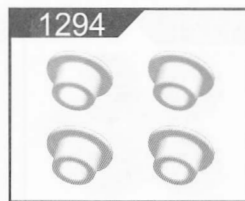

6 * 2.7 flange sleeve assembly

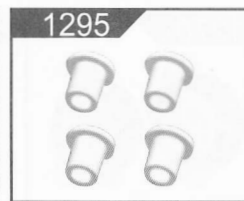

6 * 5.2 flange sleeve assembly

Sale parts view



Ball bearing assembly

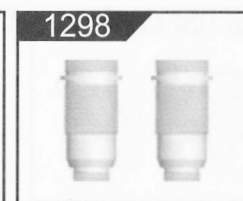

Shock absorber cylinder assembly

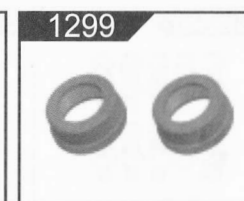

Shock absorber cap assembly

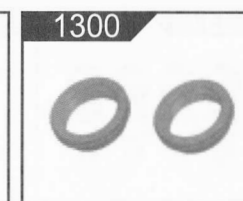

Regulate Ring Component

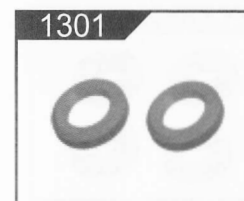

Spring seat assembly



Shock absorber assembly



Motor Block Component



Steering connecting rod assembly

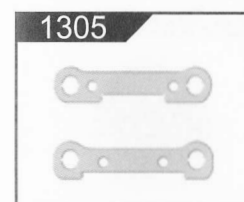

Front swing arm reinforcement module



Backswing arm reinforcement module

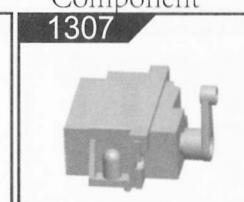

Rudder assembly



Motor components

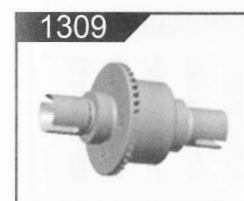

Differential

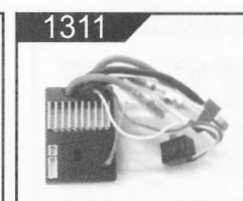

Receiver board assembly

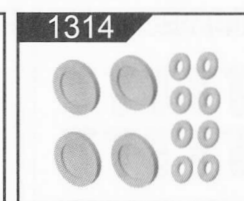

Type 0 assembly



Coaxial component

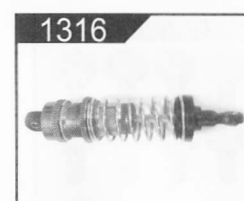

Shock absorbers



ST2.6*5KB screw assembly

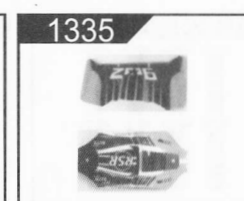



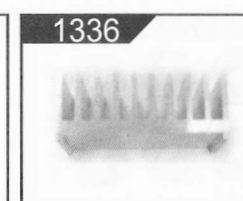



Car shell components

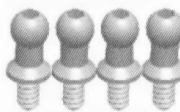
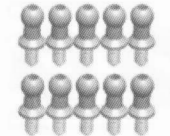
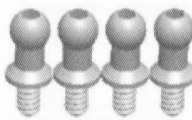
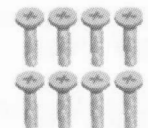
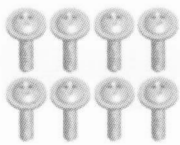
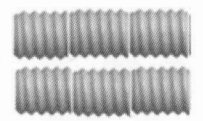

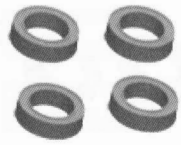
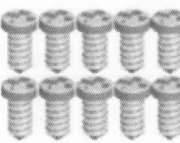
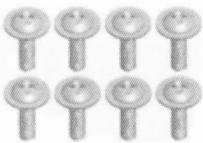
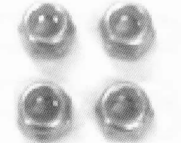
Heat Discharge Group

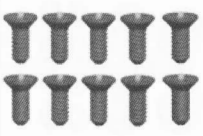
Sale parts view

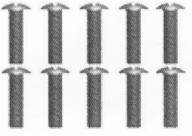
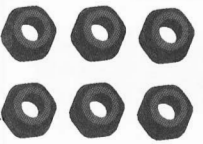
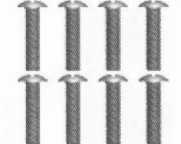
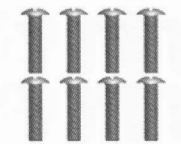
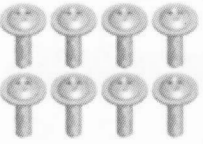
<p>1337</p> 	<p>1338</p> 	<p>A202-04</p> 	<p>A202-15</p> 
<p>4.9*13.6Ball Head screw assembly</p>	<p>4.9*10.6Ball Head screw assembly</p>	<p>4.0*9.5Ball Head screw assembly</p>	<p>ST2*8KB screw assembly</p>
<p>A303-39</p> 	<p>A929-86</p> 	<p>A949-22</p> 	<p>A949-35</p> 
<p>ST2.6*6PWB6 screw assembly</p>	<p>M3*5 Inner hexagonal screw assembly</p>	<p>Magic paste group</p>	<p>Ball bearings 7 * 11 * 3 groups</p>
<p>A949-38</p> 	<p>A949-43</p> 	<p>A949-49</p> 	<p>A959-B-15</p> 
<p>ST2.6*6PB screw assembly</p>	<p>2.5*6PWM6 Screw assembly</p>	<p>M3 Loose nut assembly</p>	<p>Motor teeth 27T group</p>
<p>A959-B-23</p> 	<p>L959-54</p> 	<p>L959-57</p> 	<p>L959-58</p> 
<p>Battery assembly</p>	<p>ST2.6*8KB screw assembly</p>	<p>ST2.6*8PB screw assembly</p>	<p>ST2.6*10PB screw assembly</p>
<p>1452</p> 	<p>1389</p> 	<p>1453</p> 	<p>1656</p> 
<p>M3 flange nut</p>	<p>3 * 20pm Cross round head machine screw</p>	<p>2*4PWM5 Cross round head machine screw</p>	<p>2.5*8PWM6 Cross round head machine screw</p>