

1:12 Electric 4WD Climbing car

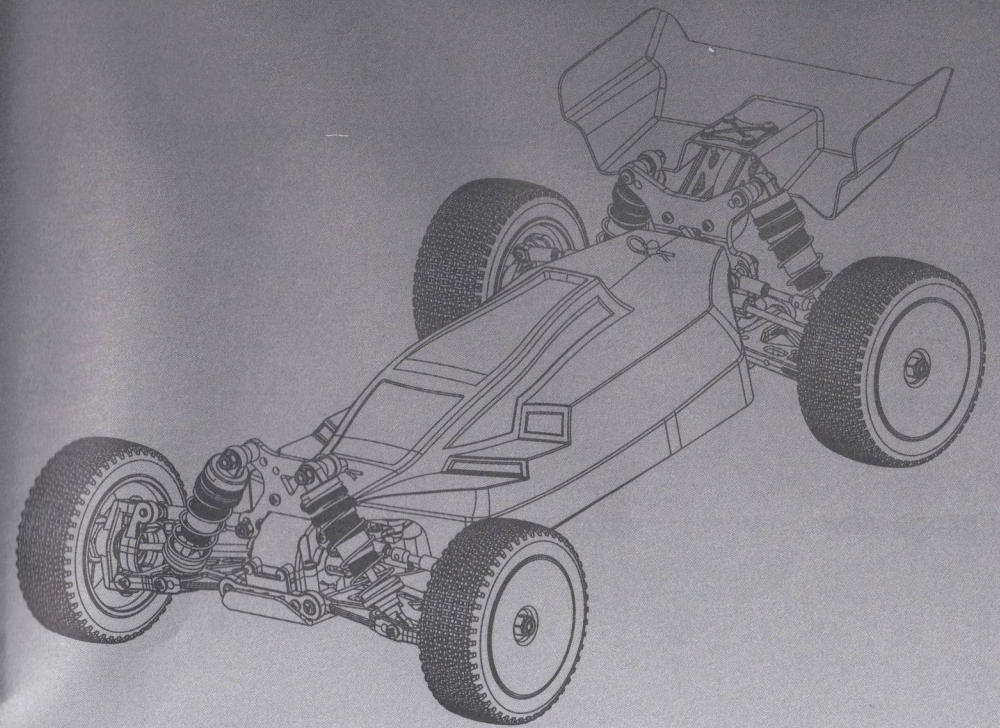

Caution: This model is not a toy, It is designed for user over 14 years of age.
Please use this instruction and the R/C system instruction at the same time.

The instruction is suitable for a type of model whose number is 124019

Safety and caution	1-2
Troubleshooting • Product introduction	2-3
Instruction of common tools and installation the electronic part... 4	
Practice and maintenance.....	5
Assemble exploded view	6-14
Fittings view	15-19

Safety and Cautions

- *Never run the model on public roads or streets, as it could endanger traffic.
- *Never run the model in crowded areas, near or toward people or animals, to prevent property damage and/or personal injury.
- *Never run the model near rivers, ponds or lakes as to prevent R/C car from dropping into the water.
- *Make sure that no one else is using the same frequency as yours in your running area. Using the same frequency at the same time, whether it is driving, flying or sailing, can cause loss of control with R/C model, resulting in serious accidents.
- *To avoid a runaway R/C model or loss of control, always follow the procedure below:
 1. Fully extend transmitter antenna.
 2. Switch on transmitter.
 3. Switch on R/C model.
- *Follow reverse procedure to shut down.
- *Never touch or hinder rotating tire.
- *Never run R/C model in the rain or let run over puddles, as water may cause trouble with R/C model.
- *Motor and battery get very hot after running. Take care when handle them.
- *Retract transmitter antenna when not in use.
- *Remove the batteries from model and transmitter when they are not in use.

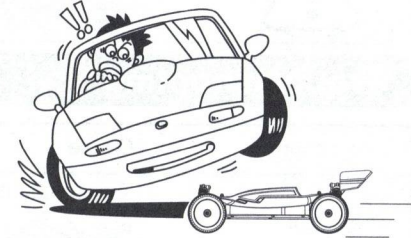

Cautions when handling batteries

- *Do not dismantle the battery or charger and do not cut any battery cables. This may cause short-circuit and/or damage to the product.
- *Change battery with compatible charger following proper procedure that is called out in the instructions. Do not modify charger or charge battery in improper way.
- *Do not recharge battery that is still warm from use as it may damage the battery. Allow the battery to cool off prior to recharging.
- *Make sure to disconnect charger cables from R/C model and electric outlet when not in use.
- *Remove transmitter battery when not using it for a long time as it may leak and damage transmitter when left for a long period.
- *Never incinerate used batteries, as they can explode causing serious accidents.



Safety precautions

<p>Do not operate the model on public roads, in crowded places or near infants, it may cause accidents or injury.</p>	<p>As the product includes small and sharp parts, assemble and store this product only in places out of the reach of children.</p>
<p>As the front end of the antenna ☆ may be dangerous, do not aim it toward faces.</p>	<p>During the car running and after, the motor will be hot. Please do not touch it until it has had time to cool down.</p>

Don't use the same frequency with others at the same time. Or the car will lose control or even lead to serious accidents.

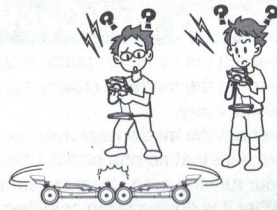

Troubleshooting

Description	Cause	Solution
The car does not operate at all.	Transmitter or receiver is off.	Turn on both transmitter and receiver.
	Batteries are not placed properly in the transmitter.	Place batteries in the transmitter properly.
	The drive battery is not charged enough.	Charge the drive battery.
The car does not follow your operation and control distance not enough long.	Someone else is using the same radio frequency as you are using.	Change your radio frequency to the one no one else is using, wait until the driver using the same radio frequency finishes driving, or drive your car at a different place.
	There is not enough power in the transmitter or receiver batteries.	Replace the transmitter batteries with new ones and charge the drive battery.
	Not tighten antenna on the transmitter/not fully extend antenna.	Make sure insert antenna into the transmitter and fully extend antenna.

CAUTION

- * Please observe the operation manual or packing explanation to install and use, and some parts should be installed by adults.
- * The product contains small part, it may cause swallow or choke.
- * Never run an R/C model in the seep or rain, moisture areas, or it may cause the parts malfunction.
- * Please throw the wrapper in time to avoid danger for the children.
- * Regularly examine for damage to the charge, wire, plug, bodyshell or other parts. In the event of any damage, it must not be used until the damage has been repaired.
- * The charge, battery box and battery must insert with the appointed power source of product symbol same.
- * This product must only be used with the original collocation charger.
- * The product is contains the functional outshoots are may be dangerous to the children.

Proportional R/C Using Instruction

- ① Turn left the steering wheel, the car will turn left. Turing left angle can be adjusted by the degree of wheel twisting.

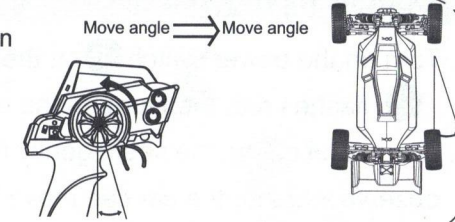

- ② Turn right the steering wheel, the car will turn right. Turing right angle can be adjusted by the degree of wheel twisting.

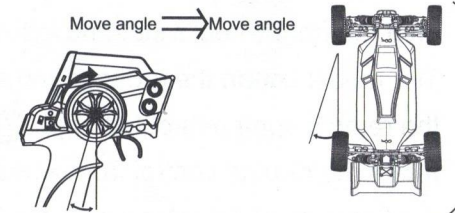

- ③ Pull the throttle trigger backward, the car will forward. Adjusting the angle of throttle trigger can adjust forward speed of the car. During the car forward, quickly push the trigger forward to stop it.

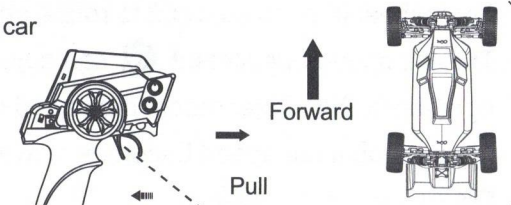

- ④ Loosen the trigger to make it return the neutral position when brake. Push the throttle trigger forward, the car will backward. Adjusting forward angle of throttle trigger adjust backward speed of the car.

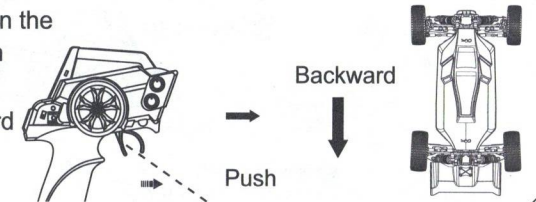

Introduce the common tools and assemble the electron parts

Tools needed for assembly

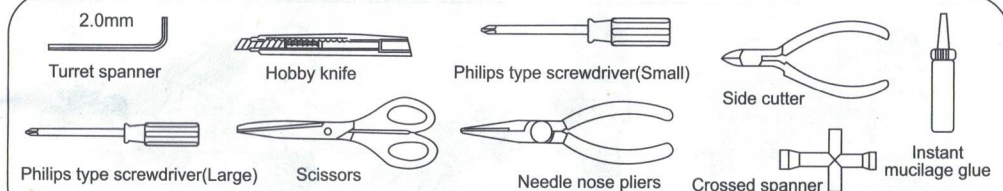

PRACTICE AND MAINTENANCE

Operating program

1. Turn on the power switch **1** on the remote and make sure the power indicator **2** flashes red, then turn on the model car's power switch.
2. The model car on the shelf, gently hook remote control on the trigger **3** to observe whether the car can move forward and backward.
3. Turn the remote control steering wheel **4** to the left or right and make sure that the front wheel's steering follows the command.
4. The model car on the ground, and standing behind the model car, gently hook the remote control throttle trigger **3**, if the model car does not go straight, rotate the remote control front wheel trim **5**, the model car to the right side, the front wheel Turn the trim to the left, the model car leans to the left, and the front wheel trims to the right to rotate until the model car can go straight.
5. Throttle speed adjustment **6** can adjust the model car speed, rotate to the right, hook the trigger model car speed becomes faster, turn left, hook the trigger model car speed becomes slower.
6. OK, ready to run.

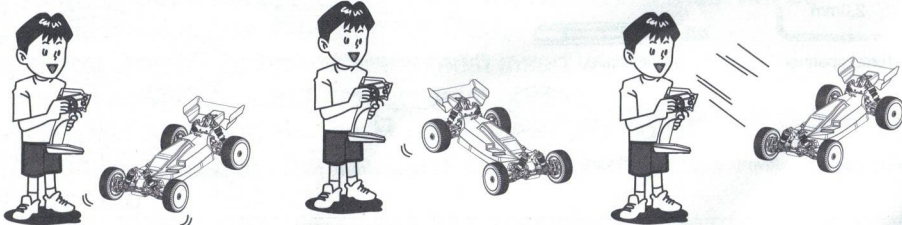
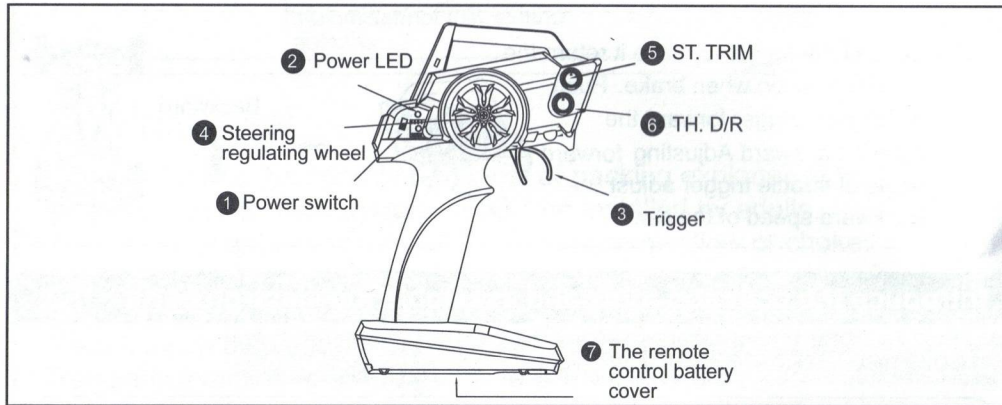

Practice

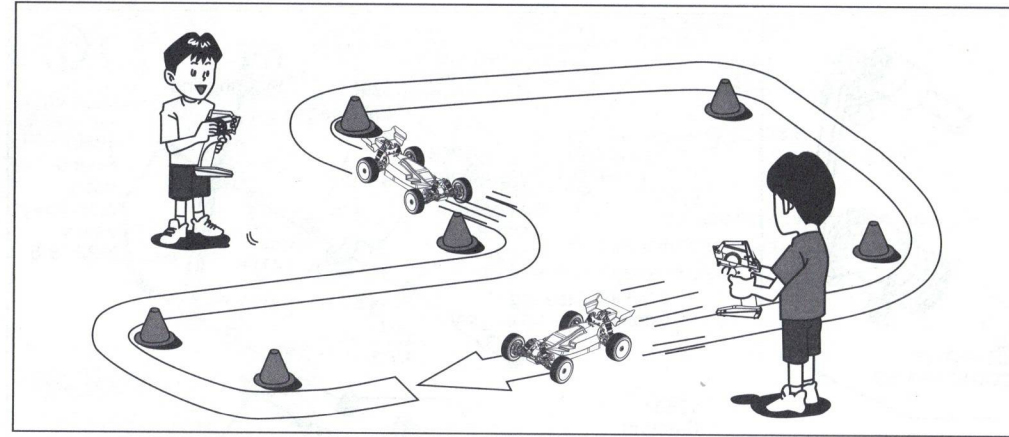

Let's practice! Make R/C car circuit at a wide and safe location using corner pylons (separately available), empty cans or such. Running fast at straight section and slow down at curved section is a basic speed control technique useful when driving R/C car.

Maintain

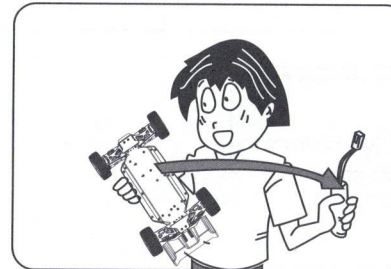

When the car is not in use, you should remove the battery from the car.

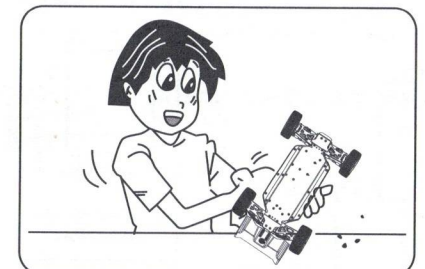

Completely remove sand, mud, dirt etc.

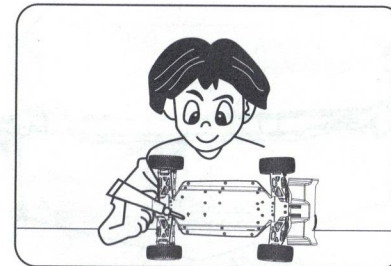

Metal outside should apply the rust prevention oil.

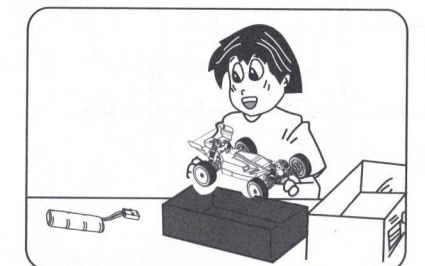

Store the car and batteries separately when not in use.

Assembly Exploded Diagram

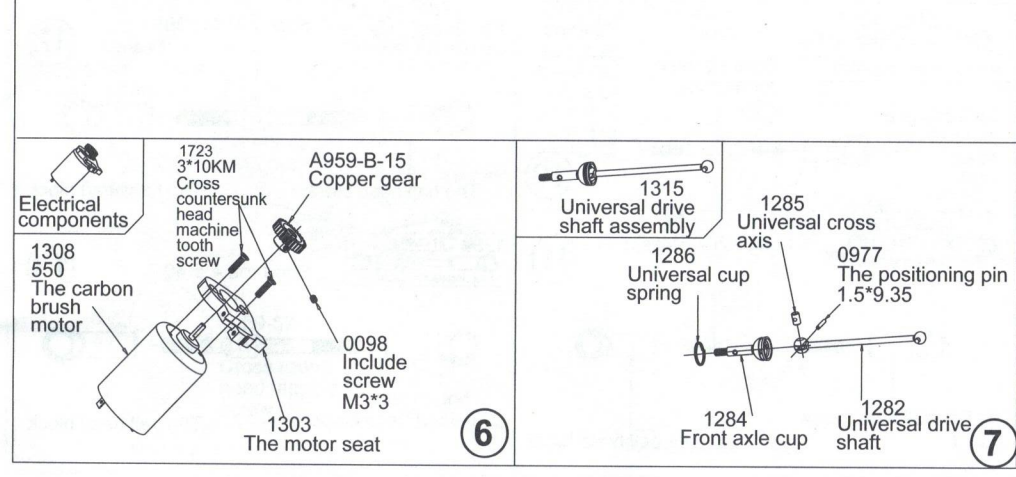
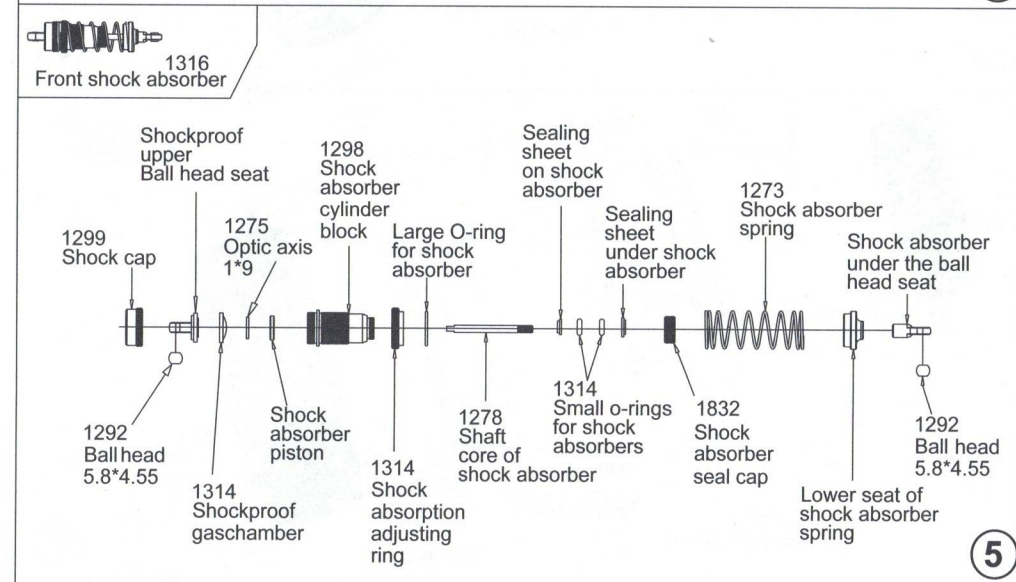
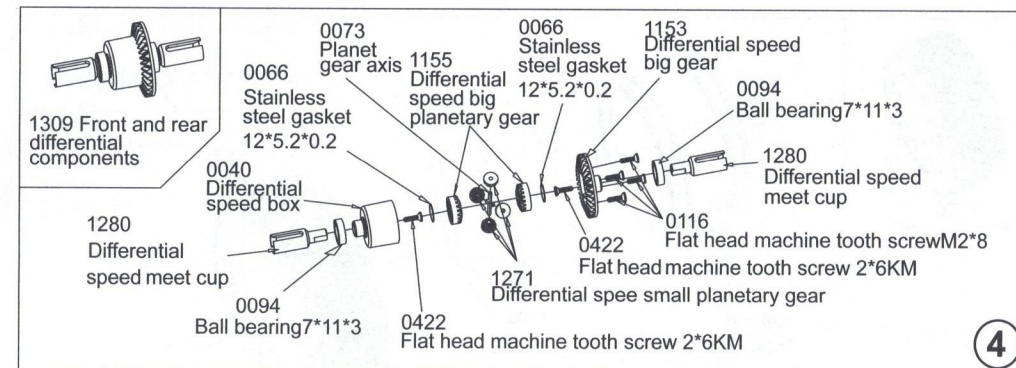
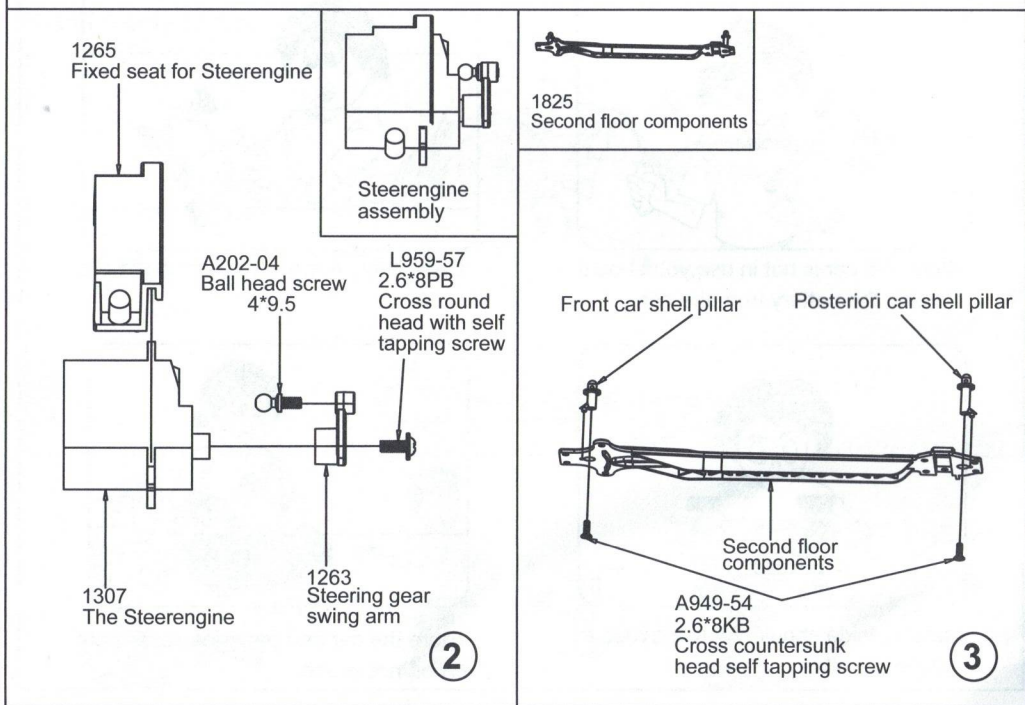
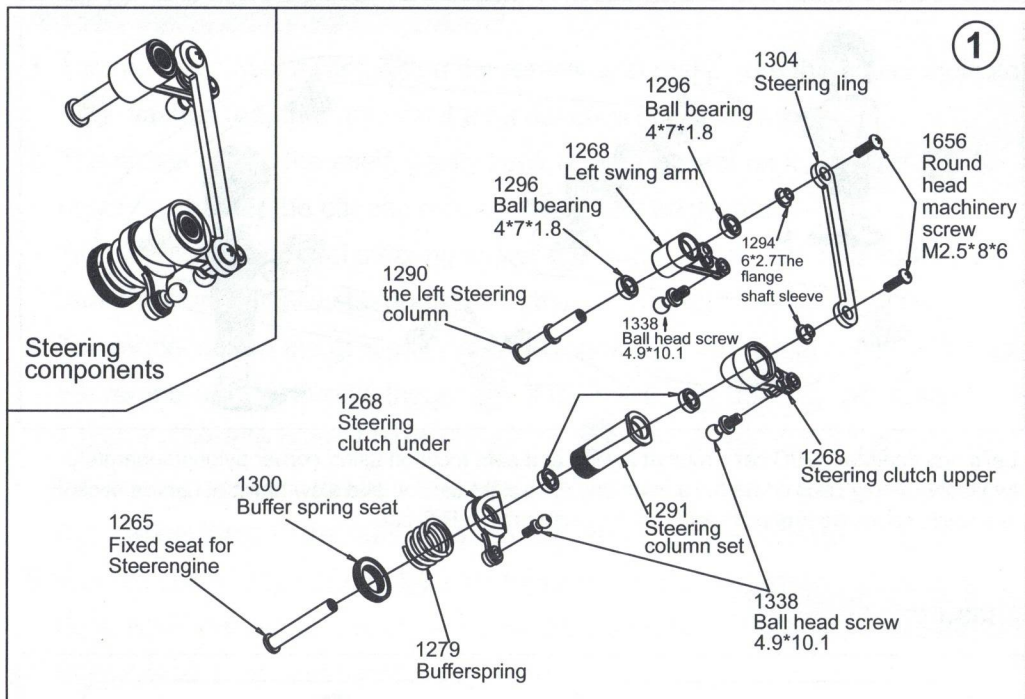

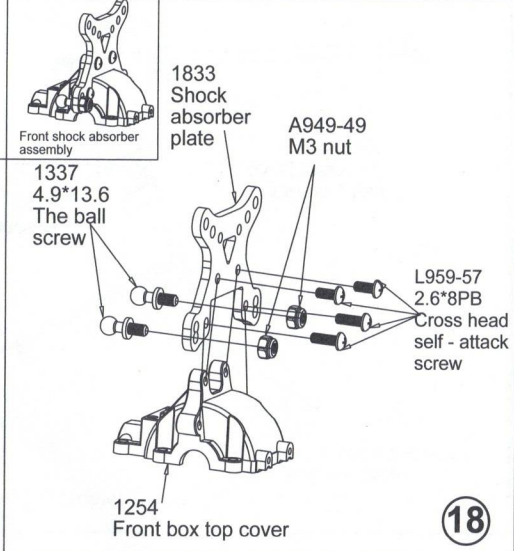
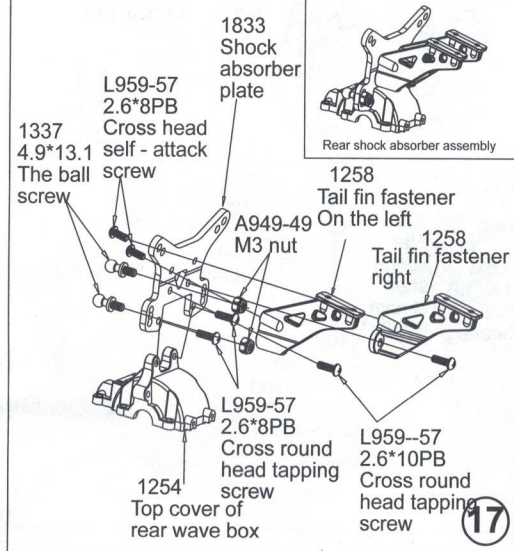
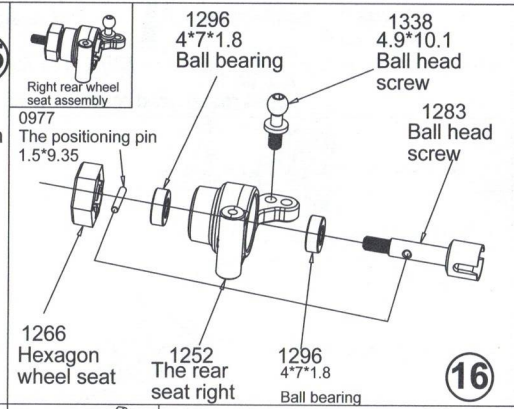
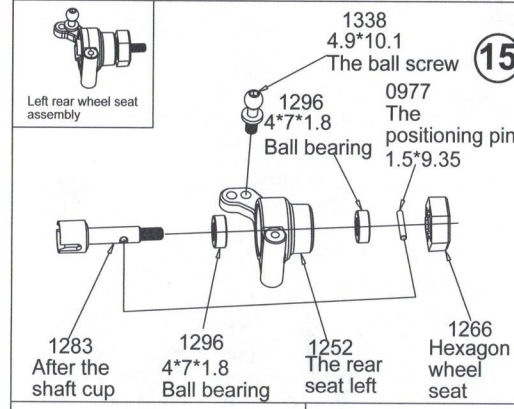
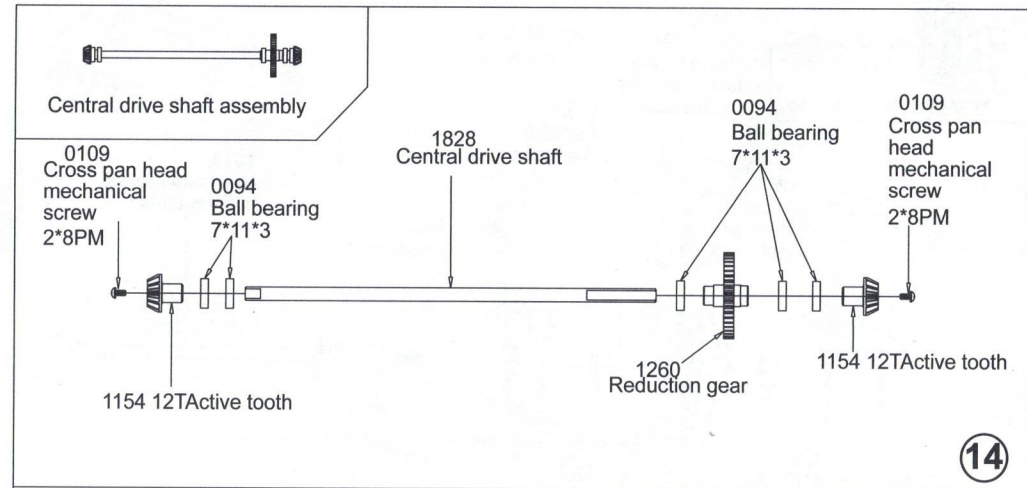
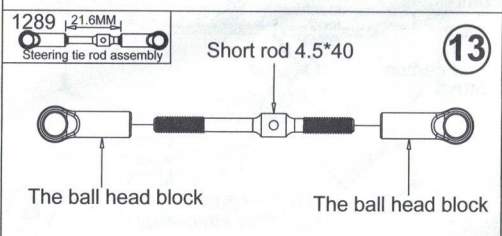
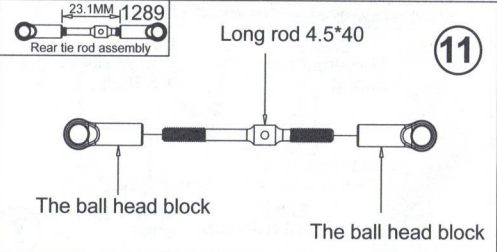
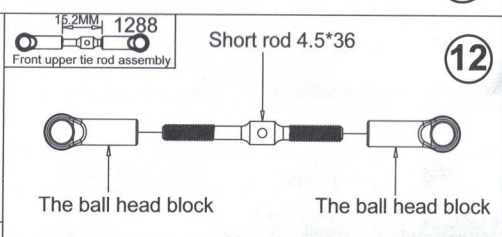
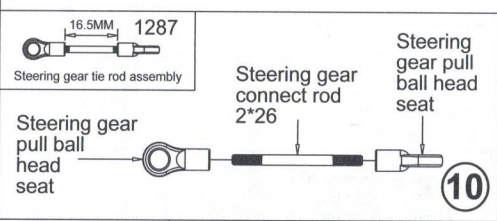
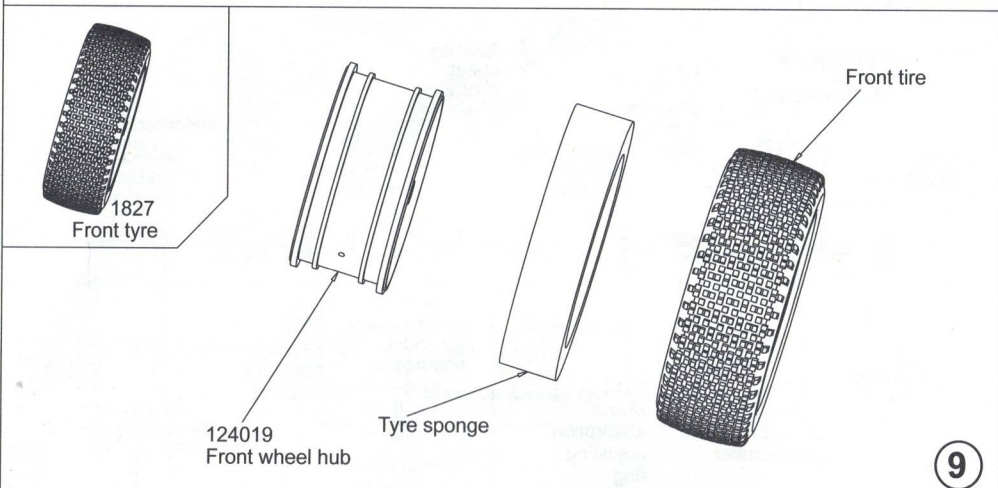
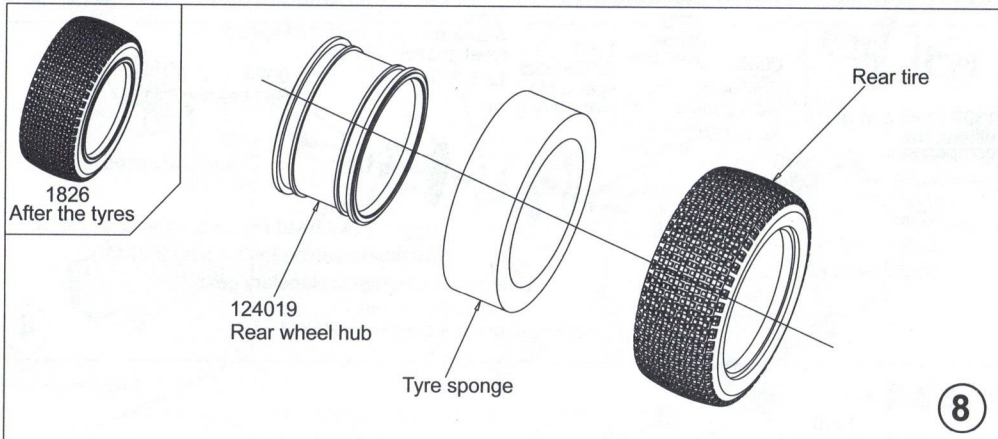

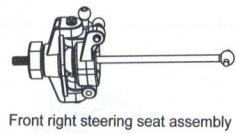

Front right steering seat assembly

0102
2.5*10PM
Cross round
head machine
tooth screw

19

1251
The front
wheel seat
right

1338
4.9*10.6
The ball screw

1315
Universal Drive S
haft Assembly

1253
C-seat right

1274
1.5*9.35
Optical axis

1266
Hexagon
wheel seat

1296
4*7*1.8
Ball bearing

1296
4*7*1.8
Ball bearing

0102
2.5*10PM
Cross round head machine tooth screw

1295

6*5.2 The flange shaft sleeve

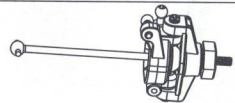

Front turn left to seat assembly

0102
2.5*10PM
Cross round
head machine
tooth screw

20

1338
4.9*10.6
The ball screw

1251
ront wheel
seat
left

1274
1.5*9.35
Optical axis

1315
Universal Drive S
haft Assembly

1253
C-seat left

1296
4*7*1.8
Ball bearing

1295
The flange
shaft
sleeve
6*5.2

1296
4*7*1.8
Ball bearing

1266
Hexagon
wheel seat

0102
2.5*10PM
Cross round
head machine
tooth screw

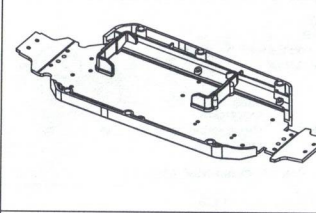

1261
Battery
compartment
partition-A

1323
Cross countersunk
head self tapping
screw
2.6*5KB

21

1824
Bottom rail right

L959-54
Cross countersunk
head self tapping
screw
2.6*8KB

1261
Battery
compartment
partition-B

1824
Bottom edge left

1323
Cross countersunk
head self tapping
screw
2.6*5KB

L959-54
Cross countersunk
head self tapping
screw
2.6*8KB

124018 Vehicle bottom

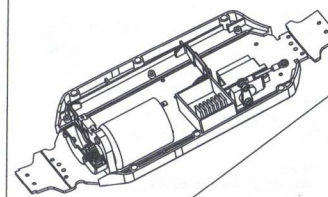

Motor assembly

1287
Steering gear tie rod assembly

22

Steerengine assembly

0114
2.5*8KM
Cross countersunk head self tapping screw

A949-54
2.6*8KB
Cross countersunk head self tapping screw

Rear wave box assembly

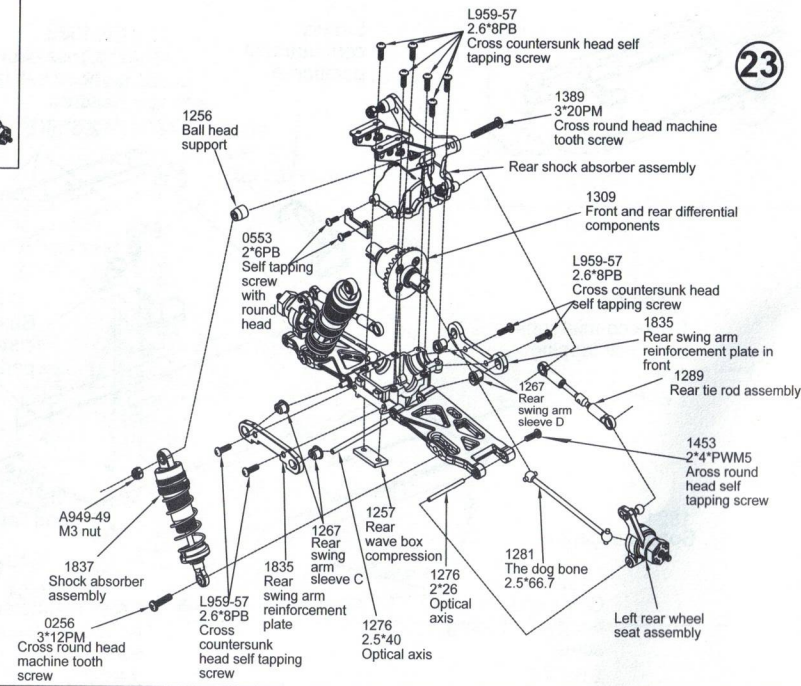

23

Front wave box assembly

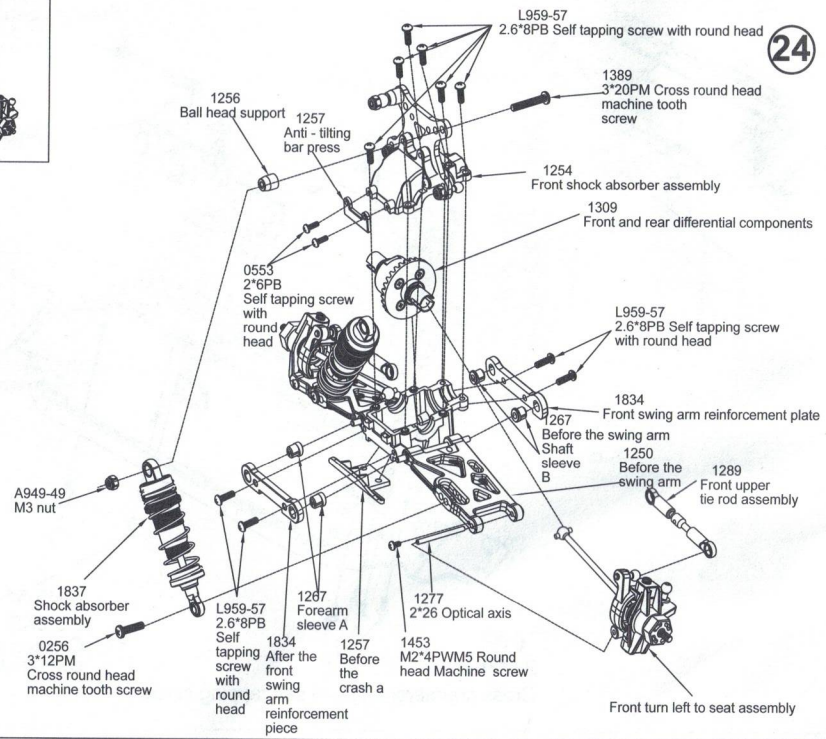

24

Reduction gear cover

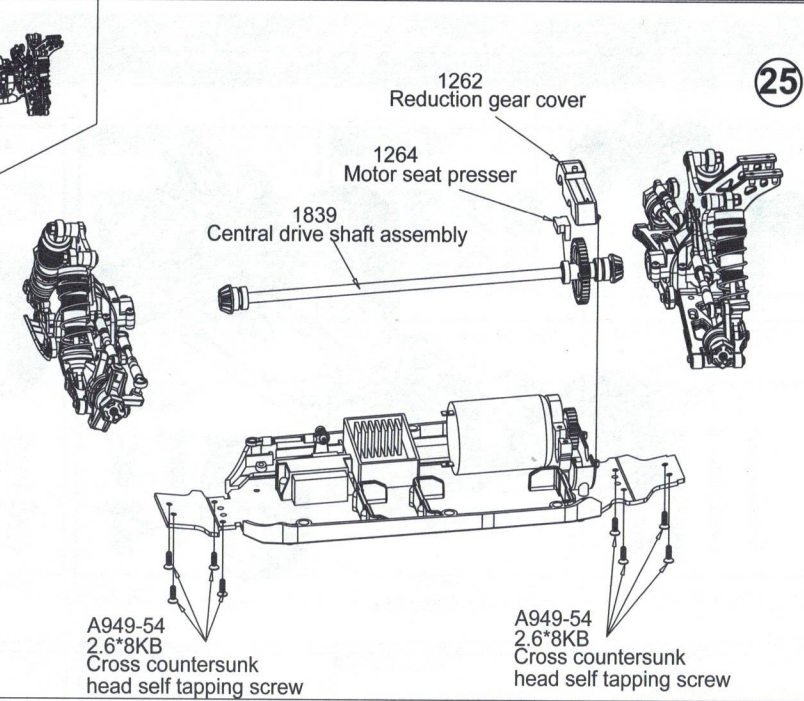

25

Front turn left to seat assembly

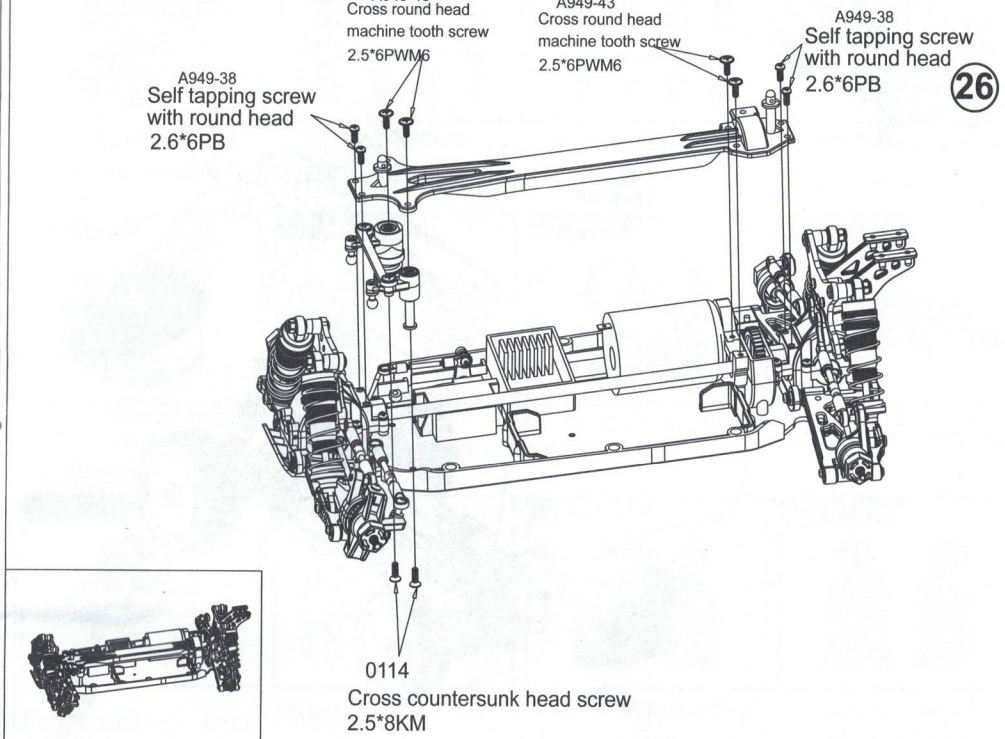

26

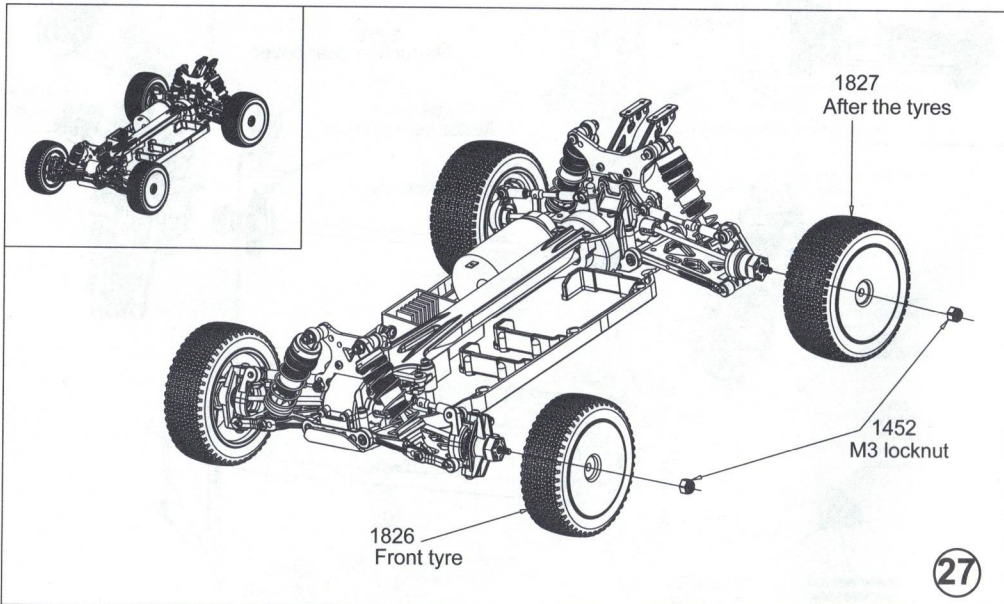

27

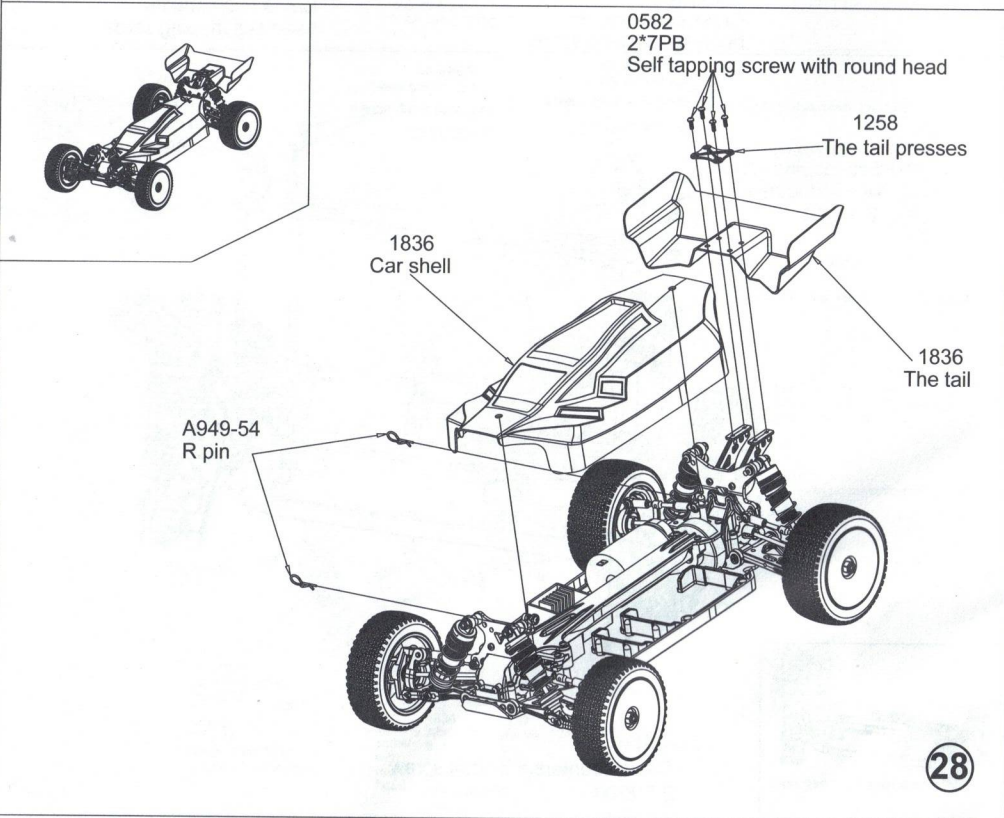

28

Sale parts view

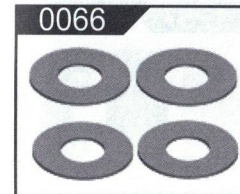

0066
12 * 5.2 * 0.2 gasket set assembly

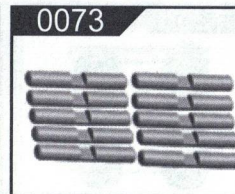

0073
Differential shaft assembly

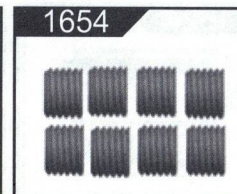

1654
M3*3 Inner hexagonal screw assembly

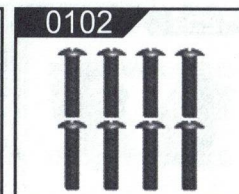

0102
2.5*10PM screw assembly

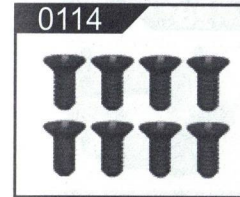

0114
2.5*8KM screw assembly

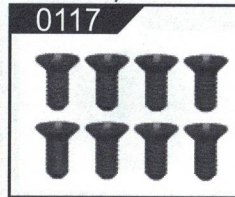

0117
3*8KM screw assembly

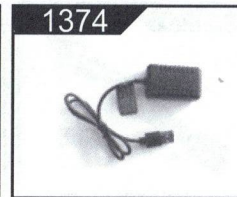

1374
USB charging line

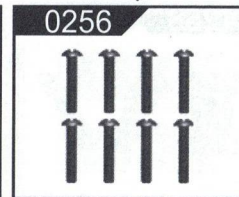

0256
3*12PM screw assembly



1669
V2-144001 Remote controller

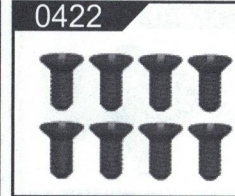

0422
2 * 6KM screw assembly



0553
2 * 6PB screw assembly



0582
ST2*7PB screw assembly



1153
30T Differential Large Teeth(Hardware) Component

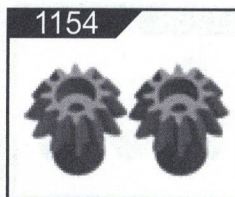

1154
12T Active Teeth(Hardware) Group

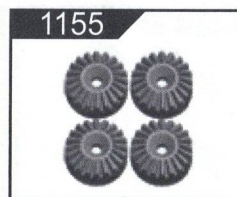

1155
24T Differential Large Planetary Teeth(Hardware) Group

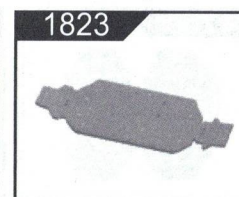

1823
car body assembly

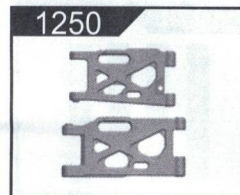

1250
Front and rear arms

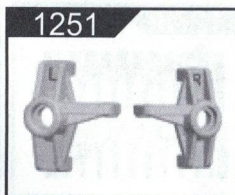

1251
Front seat assembly



1252
Rear seat assembly





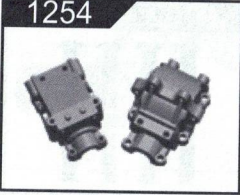
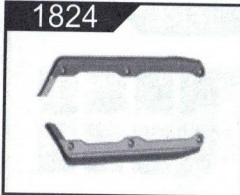
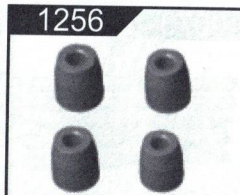
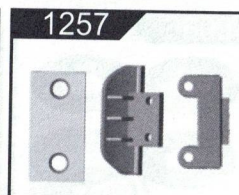
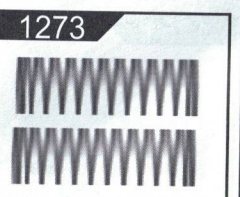

1253
Type C Block Component

Sale parts view

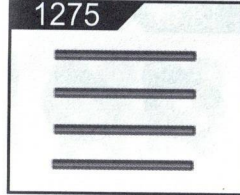
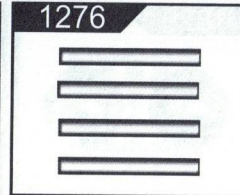
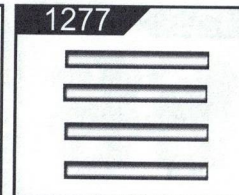
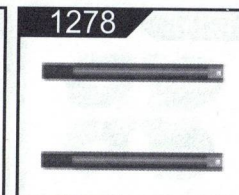
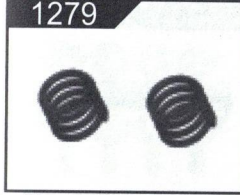
 1254	 1824	 1256	 1257
Wave Box Component	Bottom side guard assembly	Ball head support assembly	Anti-collision accessories components
 1258	 1825	 1260	 1261
Final-end firmware component	Second floor panel components	Slow down large tooth assembly	Battery partition assembly
 1262	 1263	 1264	 1265
Speed gear upper and lower cover assembly	Tiller arm assembly	Motor seat press component	Steering seat press assembly
 1266	 1267	 1268	 1826
Hexagonal seat assembly	Front and rear arm sleeve	Switch to clutch component	Front tire assembly
 1827	 1271	 1273	 1274
Back tire assembly	10T Differential Asteroid Teeth(Hardware) Group	Shock absorber spring assembly	1.5*9.35 Optical axis

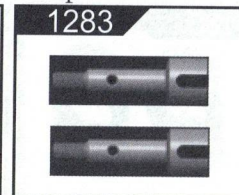
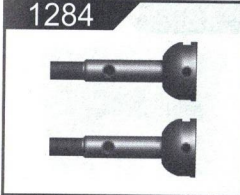
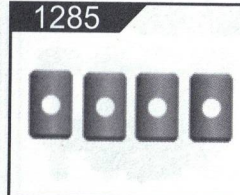
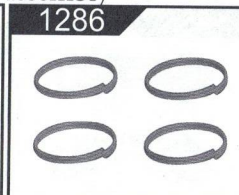
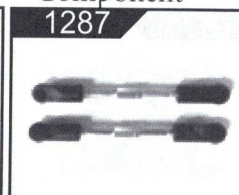
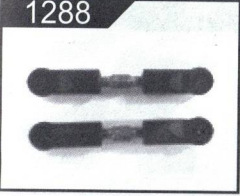
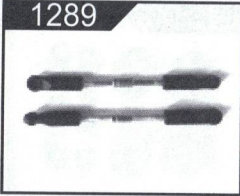
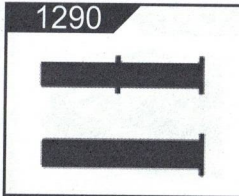
Sale parts view

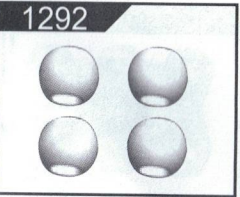
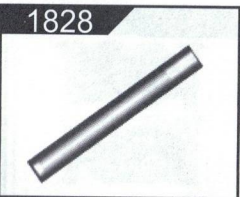
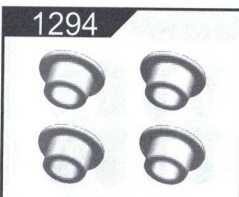
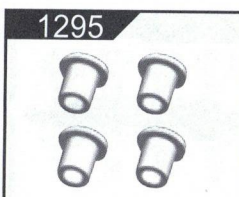
 1275	 1276	 1277	 1278
1*9 Optical axis	2.5*40 Optical axis	2*26 Optical axis	Shock absorber shaft component
 1279	 1281	 1282	 1283
Buffer spring assembly	Dog bone assembly	Universal drive shaft assembly	Rear Wheel Cup Component
 1284	 1285	 1286	 1287
Front Wheel Cup Component	Cross shaft assembly	Universal cup spring assembly	Steering gear lever assembly
 1288	 1289	 1290	 1291
Short pull bar assembly	Long pull bar assembly	Steering column assembly	Steering column sleeve component
 1292	 1828	 1294	 1295
Ball Head Component	Central Transmission Axis Component	6 * 2.7 flange sleeve assembly	6 * 5.2 flange sleeve assembly

Sale parts view

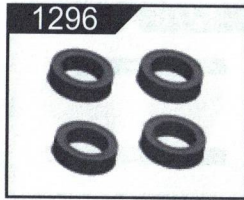

1296
Ball bearing assembly

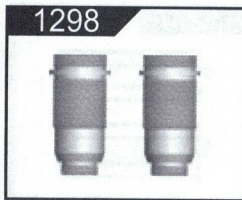

1298
Shock absorber cylinder assembly

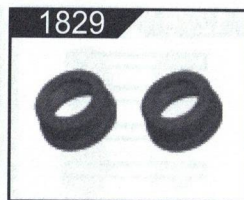

1829
Shock absorber cap assembly

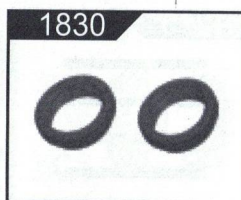

1830
Regulate Ring Component

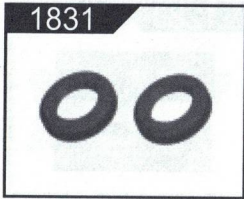

1831
Spring seat assembly



1833
Shock absorber assembly



1303
Motor Block Component



1304
Steering connecting rod assembly

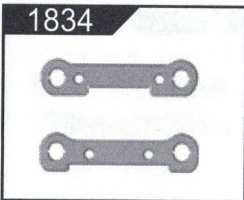

1834
Front swing arm reinforcement module



1835
Backswing arm reinforcement module



1307
Rudder assembly



1308
Motor components



1309
Differential

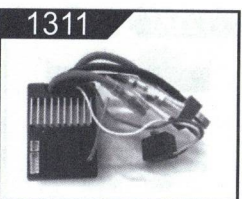

1311
Receiver board assembly

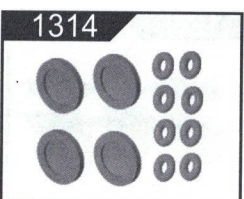

1314
Type 0 assembly

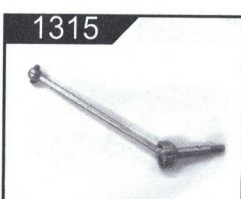

1315
Coaxial component

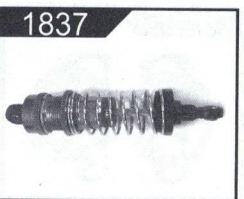

1837
Shock absorbers

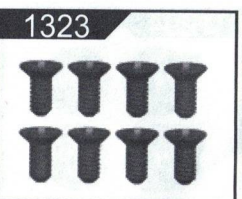

1323
ST2.6*5KB screw assembly

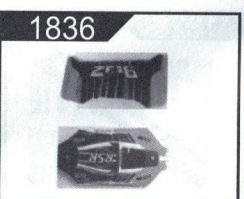

1836
Car shell components

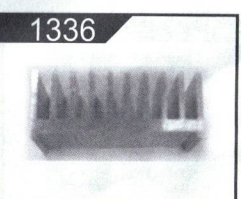

1336
Heat Discharge Group

Sale parts view

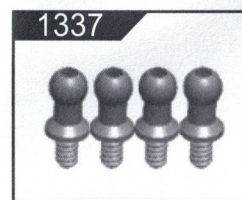

1337
4.9*13.6 Ball Head screw assembly

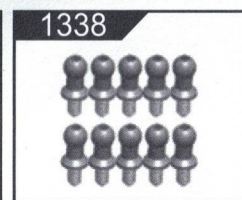

1338
4.9*10.6 Ball Head screw assembly



A202-04
4.0*9.5 Ball Head screw assembly

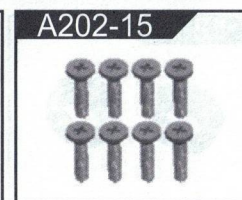

A202-15
ST2*8KB screw assembly

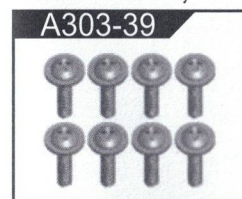

A303-39
ST2.6*6PWB6 screw assembly



1839
Central drive shaft assembly

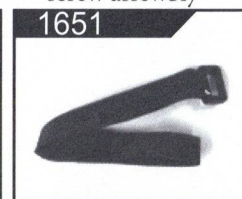

1651
Magic paste group



A949-35
Ball bearings 7 * 11 * 3 groups



A949-38
ST2.6*6PB screw assembly



A949-43
2.5*6PWM6 Screw assembly



A949-49
M3 Loose nut assembly



A959-B-15
Motor teeth 27T group

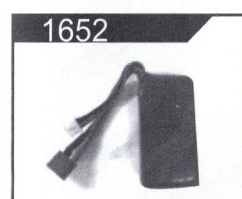

1652
Battery assembly

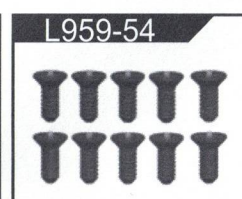

L959-54
ST2.6*8KB screw assembly



L959-57
ST2.6*8PB screw assembly

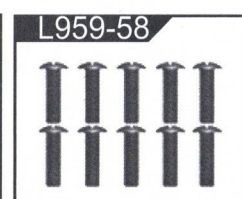

L959-58
ST2.6*10PB screw assembly

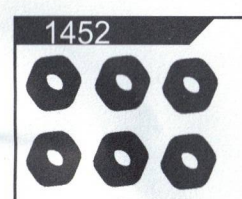

1452
M3 flange nut

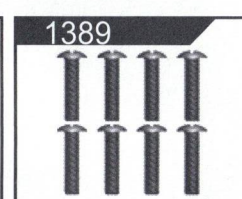

1389
3 * 20pm Cross round head machine screw

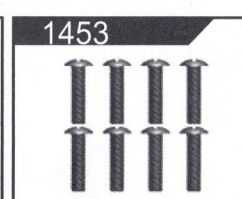

1453
2*4PWM5 Cross round head machine screw



1656
2.5*8PWM6 Cross round head machine screw

Sale parts view

1832

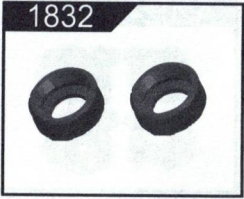

Shock proof sealing
cap 11 * 4.5 sets